

ヨーロッパの街並みシリーズ

1/87 Scale STREETS of EUROPE

ITALY



Necessities

Cutter knife



Ruler



Tweezers

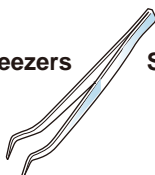

Scissors

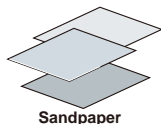

Sandpaper

● Prepare from 120 grit to 400 grit

● Button battery CR2032



Wood glue



Fast-drying wood glue

● This glue can also be used for gluing wood and metal together. Mistakes cannot be fixed, so use with care.

Convenient

「All purpose wood glue」

● This glue is aqueous adhesive. It can be used for gluing wood, leather, cloth, paper or previous materials and metal together.



● It is useful to work on sandpaper with double-sided tape on the disposable chopsticks, round sticks, block of wood.

※ We deal in tools and adhesive, paint.

Painting



Painting knife



Masking tape width 10mm

Paints



Paints name	Chromium oxide green	Yellow oxide	Titanium white	Ceramic Stucco	Special oil stain by woodyjoe
No.	6031	6052	6065	Texture gel	Wood brown (light brown)
Where used	Door with window	Exterior wall	Exterior wall	Plaster for exterior wall	Tile, door on the first floor



CAUTION

* Please read before assembly

- This is an assembly model. Please read the instructions before starting assembly.
- Please make sure to dispose of the plastic bags after taking out the parts to avoid danger to children from suffocation or swallowing.
- Sand wooden parts until smooth, and throw away all rubbish. Wooden bars break easily, so please handle them carefully. Be especially careful if children are present.
- Do not use the parts for other purposes because some parts have sharp edges. Be especially careful if children are present.
- This kit contains small parts, so please do not swallow them by mistake. Take extra cautions if you have small children. Accidental ingestion may cause suffocation.
- Use of nippers, knives, sandpaper, and files for purposes other than those intended for the assembly of this kit may lead to injury. Please be careful when using these tools. If you are under 12 years old, please assemble this kit with a parent or guardian.
- When using adhesives and paint, please be mindful of the following:
 - Do not use them in an enclosed room. There is a danger of intoxication.
 - Do not use them near open flames. These materials are flammable.
 - Do not put these materials in your mouth or eyes. If swallowed or taken by mistake, immediately wash out the affected areas with water. Afterwards, please consult your physician.
- Please note the parts are subject to change without notice.



WoodyJOE
ウッディジョー

Oya691 Suruga ward, Shizuoka, 422-8017
TEL.054-298-6200 Fax054-283-8586

E-mail: info@woodyjoe.com
http://www.woodyjoe.com

《Parts List》

※Tools, adhesives, paint, etc. are not included with this kit.
Please purchase separately.

Please make an inquiry about the purchase of paints,
adhesives, tools.

FAX 054-283-8586

TeI 054-298-6200

Laser Wooden Parts		
No.	Parts Name	Qty
1	Tower, plate wall on the left of the house, others	①
2	Plate wall on the right of the house, others	①
3	Stone steps on the left of the house	①
4	Door, others	①
5	Stone steps on the center	①
6	Door, window, others	①
7	Door, window, wall, others	①
8	Clock, wall of stair	①
9	Exterior wall	①
10	Stone for wall surface	①
11	Parts for the top of the tower, stone for wall surface	①
12	Bricks	①

Wooden Parts		
No.	Parts Name	Qty
13	Plate of pedestal 3x200x290	1
14	Roof tile 11mm 3x32x11	4
15	Roof tile 20mm 3x32x20	4
16	Roof tile 27mm 3x32x27	5
17	Roof tile 33mm 3x32x33	3
18	Roof tile 37mm 3x32x37	7
19	Stick 0.5x3x200	1

Other Parts		
No.	Parts Name	Qty
1	Brass nail	1
Other Parts		
1	Land sponges for grass	1bag
2	Land sponges for red flower	1bag
3	Land sponges for pink and white flower	1bag
4	LED Chip light	1
5	3V button battery holder for CR2032	1
6	Rope	1
7	Translucent film	1sheet
8	Paper for the clothes	1
9	Paper for the stone wall	1

Please prepare button battery(CR2032) separately.

1 《Assemble the wall on the left side of the house》



● Laser-cut parts
● Cut off the laser-cut parts by cutting the connecting parts from the surface or back side.

- Cutting the translucent film, stick it on the hole of the back of ①0.
- ※Please tape(the double-sided tape) film or stick all purpose wood glue in places. (Roughness is inside.)

【Front wall】

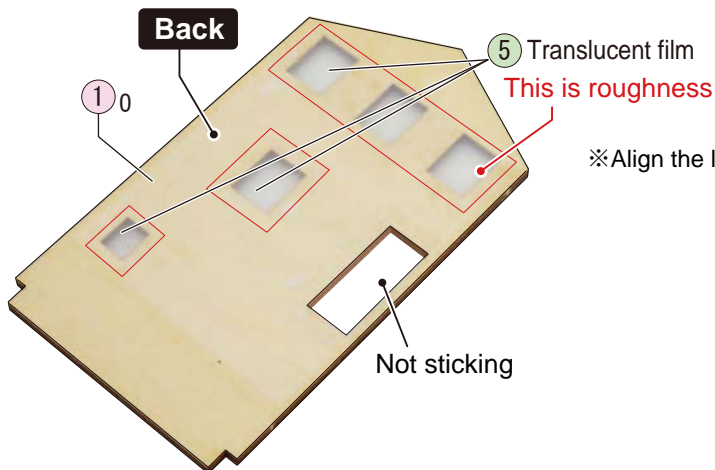

※Align the lower surface. ⑥D

※Align the lower surface. ⑥C

Front

※Align the lower surface. ⑥J

Translucent film on the back

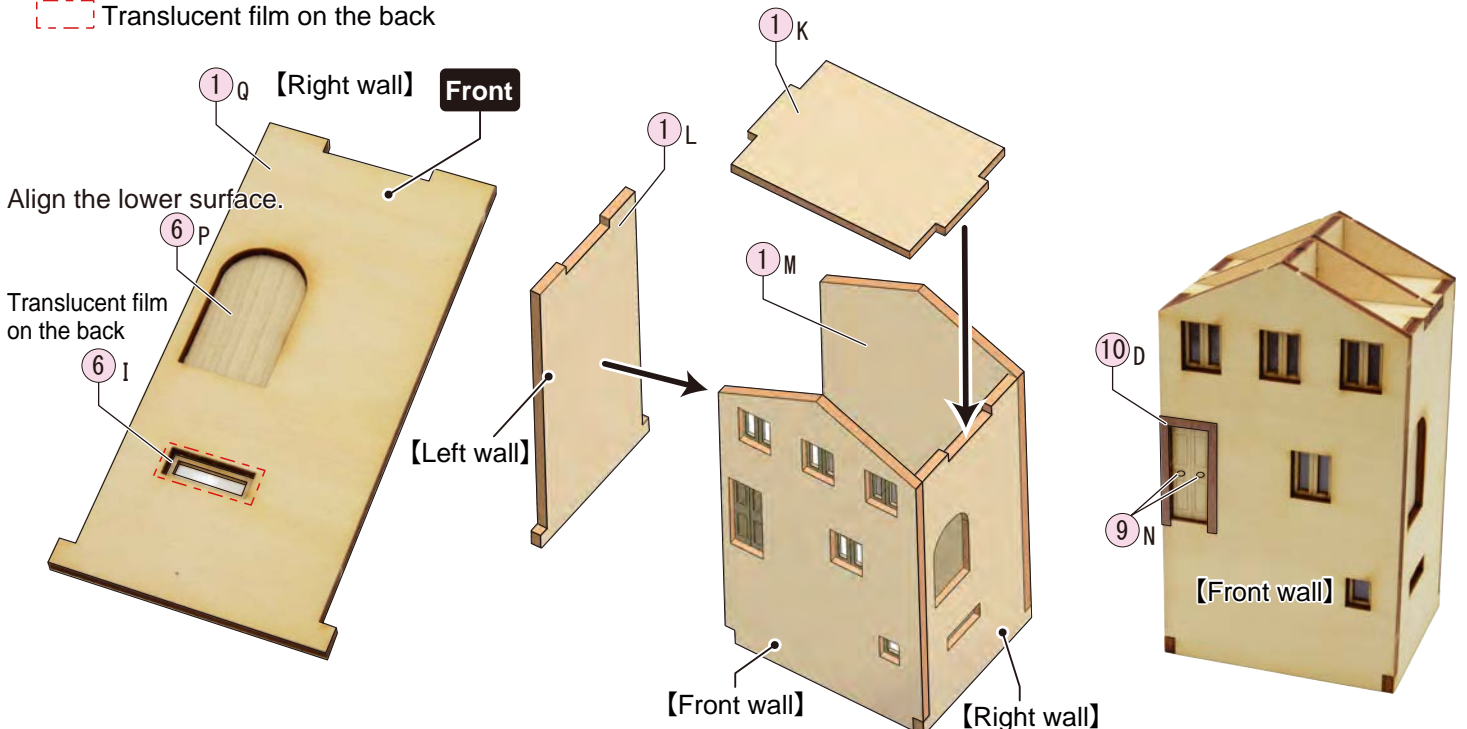

2

《Assemble the roof base of the left house》

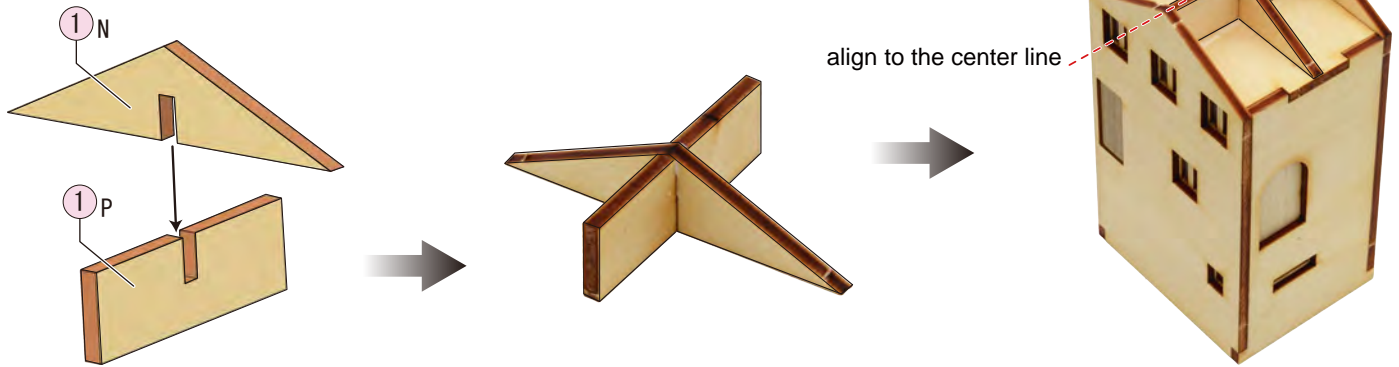

3

《Assemble the wall of the right house 1》



Translucent film on the back

● Stick the translucent film on the back of the window.

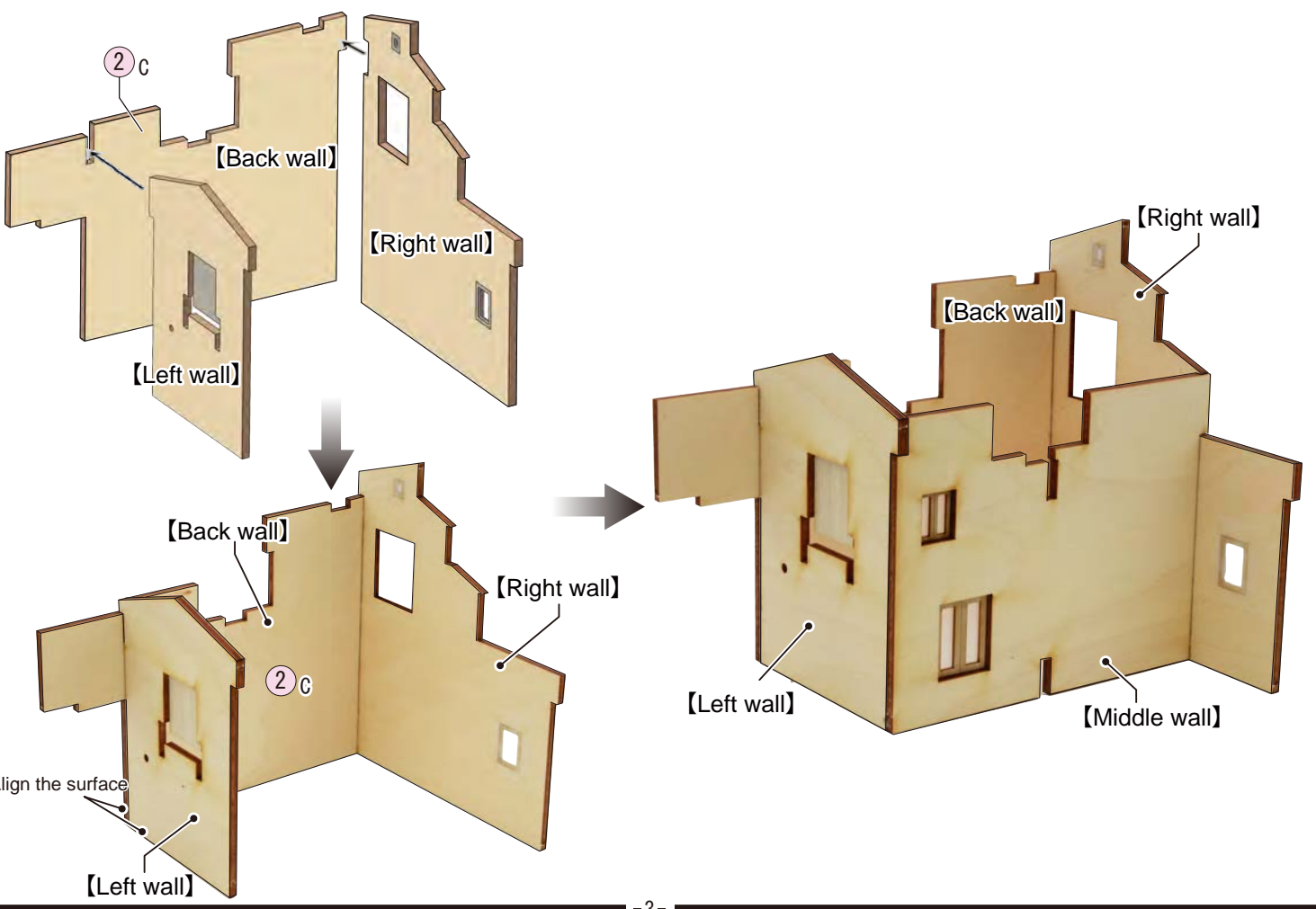
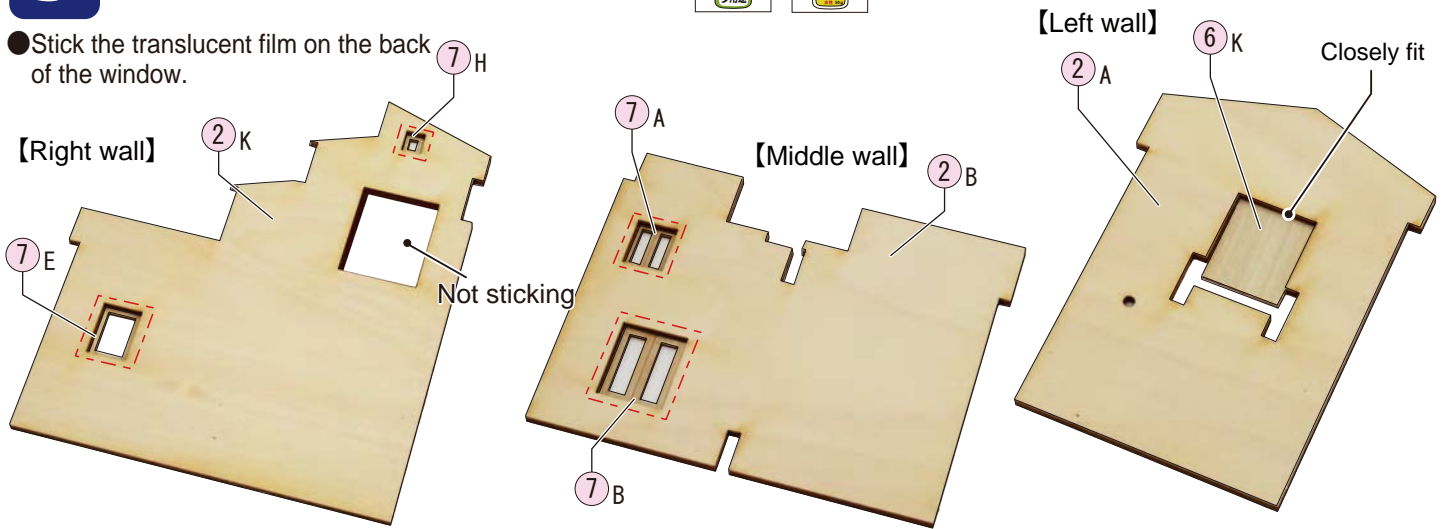

4

«Assemble the wall of the right house 2»

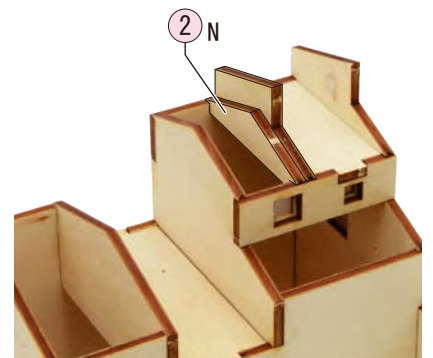
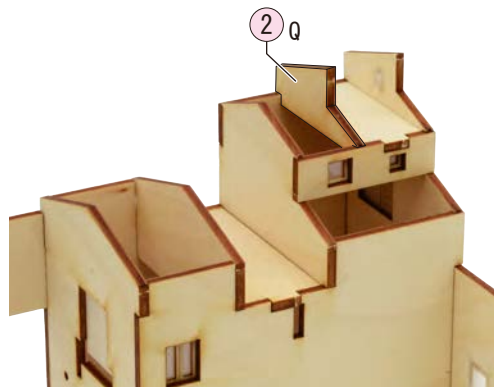
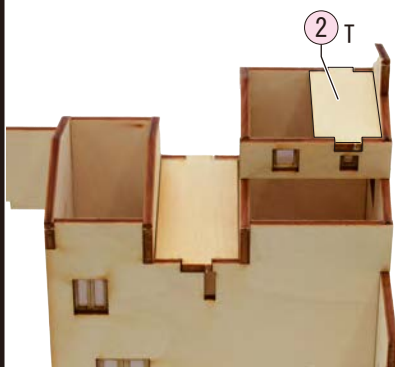
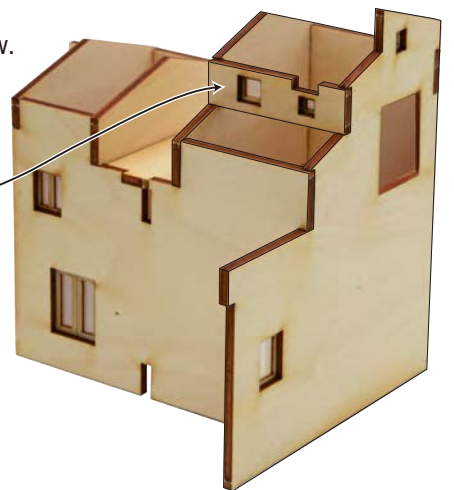
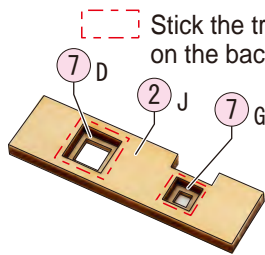
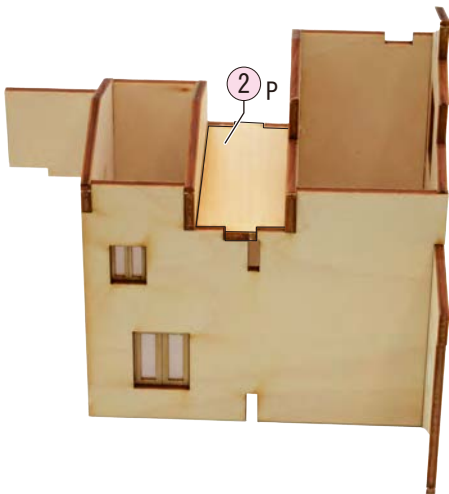
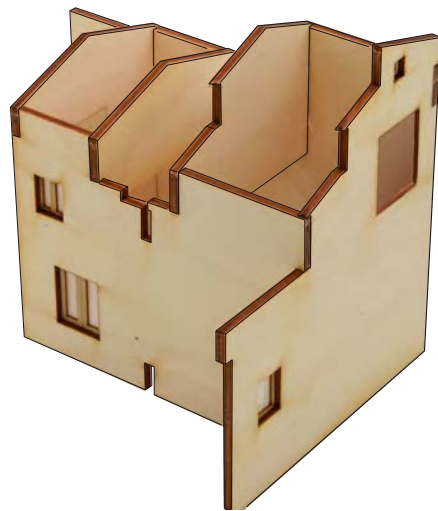
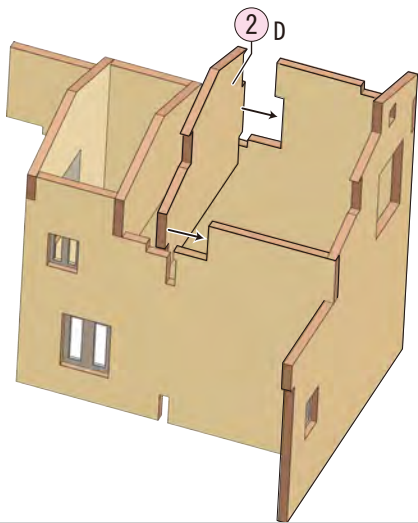
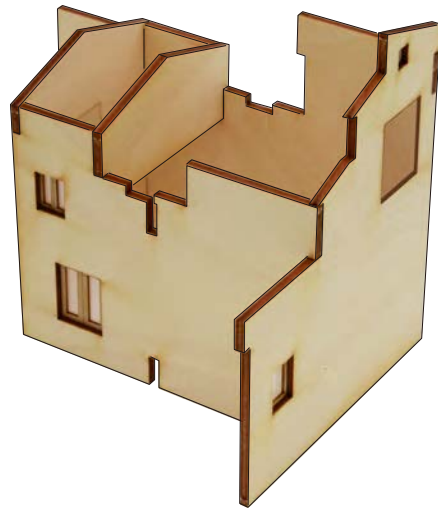
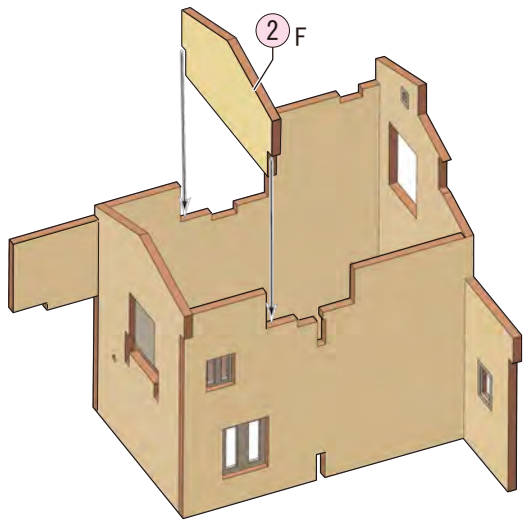

5 «Assemble the wall of the right house 3»

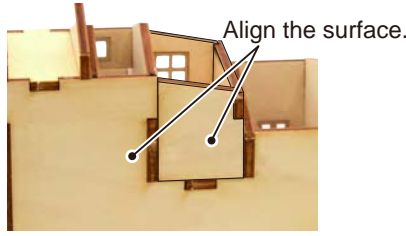

Translucent film on the back

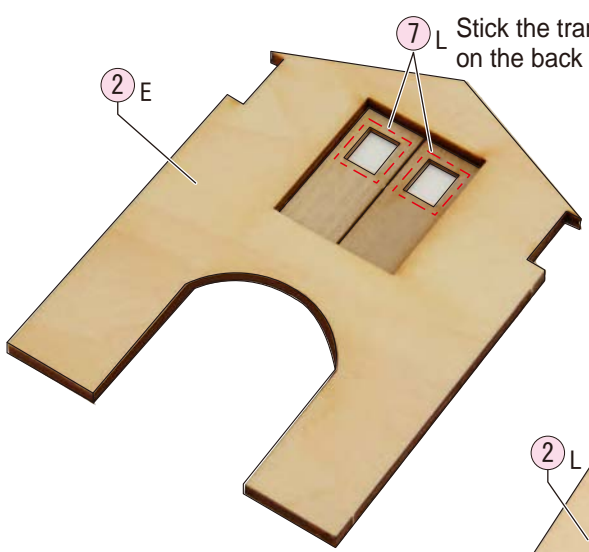
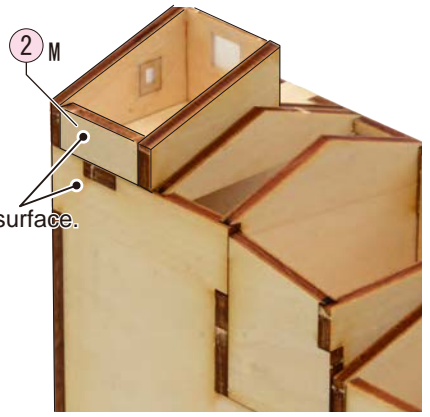
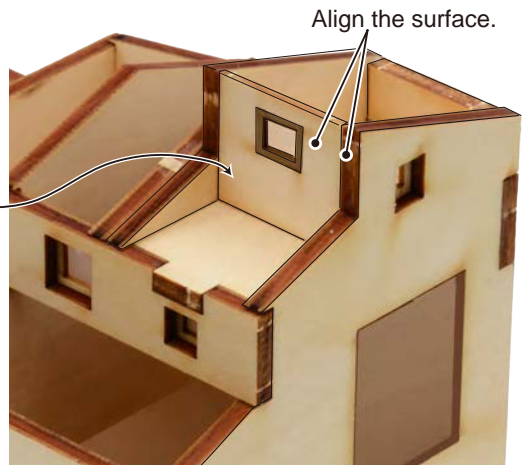
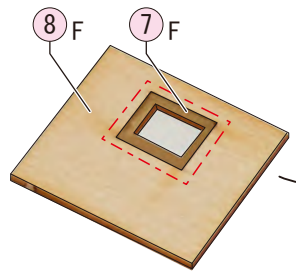
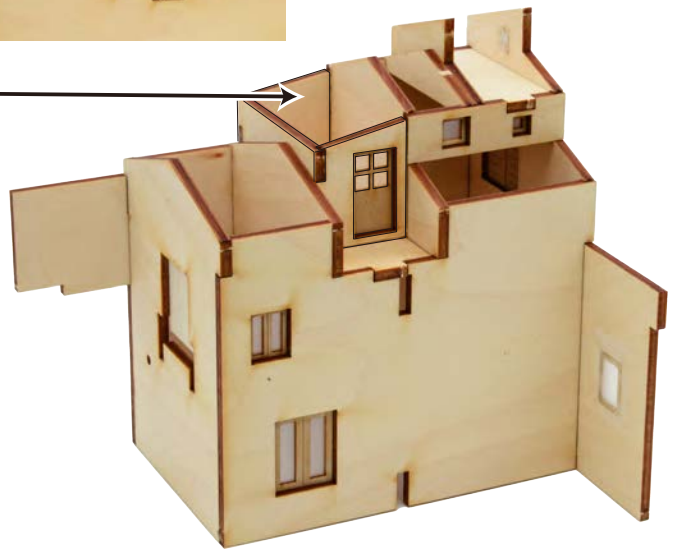
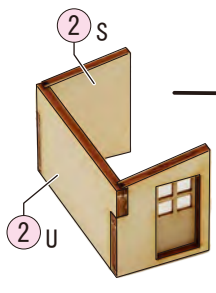
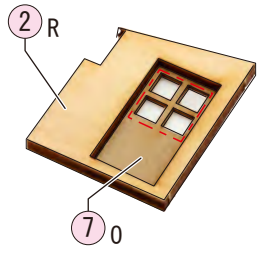

7L Stick the translucent film on the back of the window.

Stick the translucent film on the back of the window.

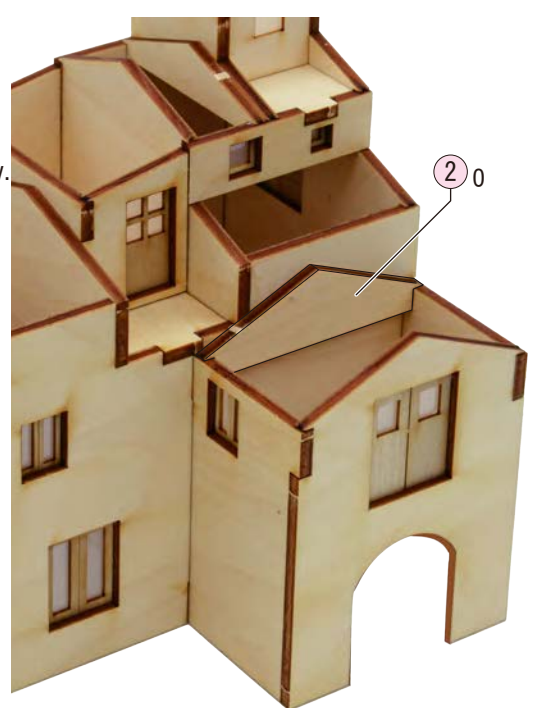
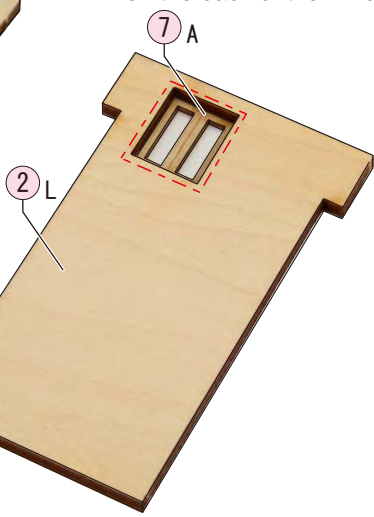

6

《Assemble the wall of the right house 4》

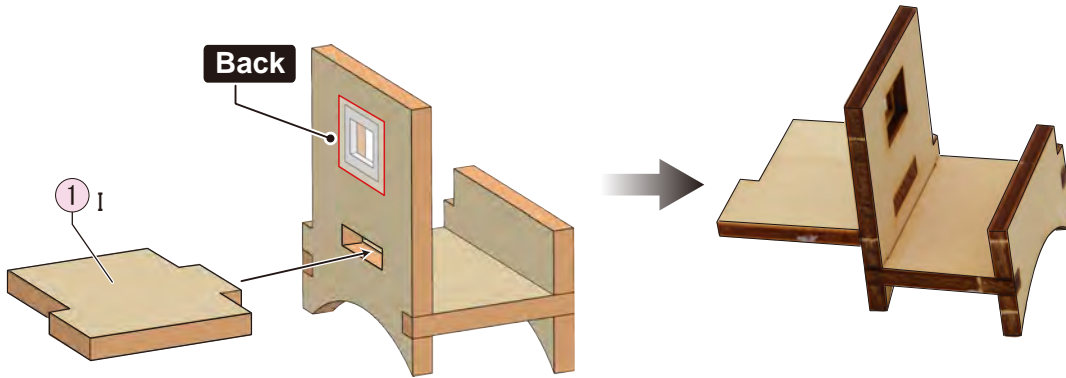
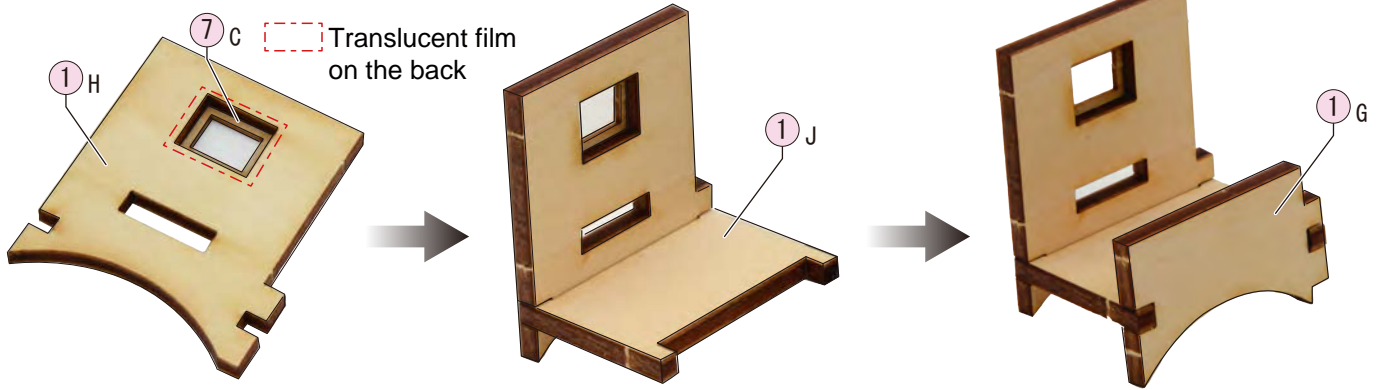

※If it is too narrow, adjust to sand it.

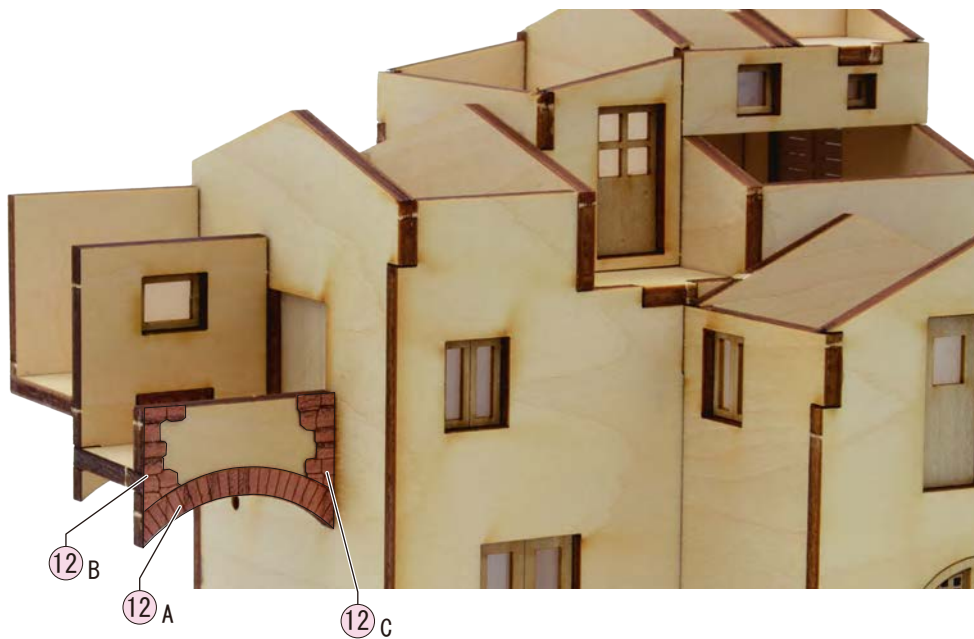
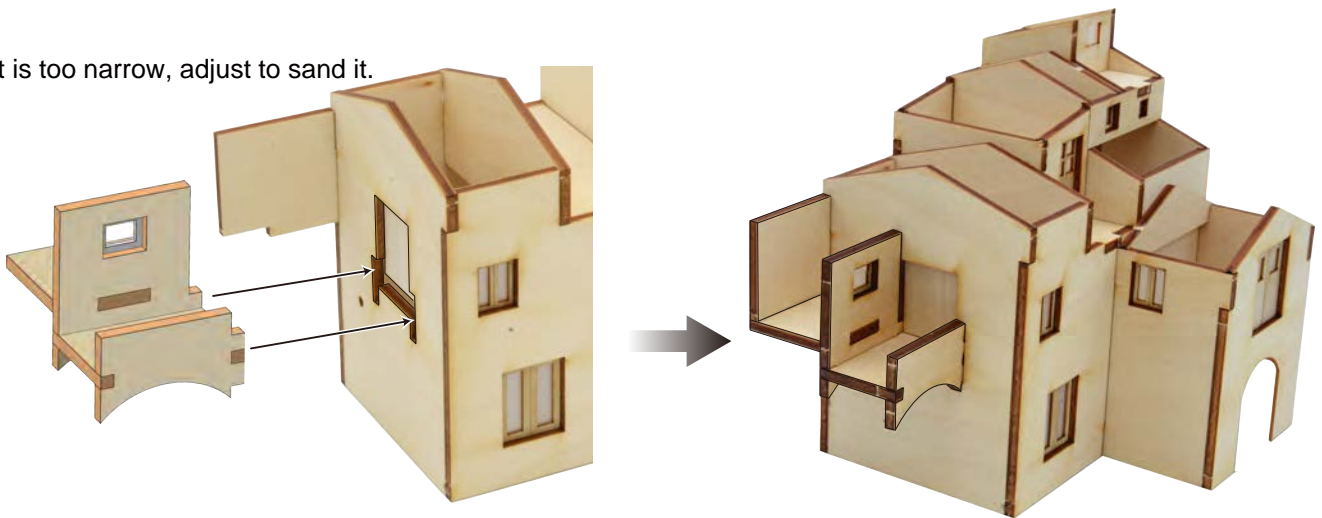

7

《Assembly of the stairs》



【The stairs of the house on the left】

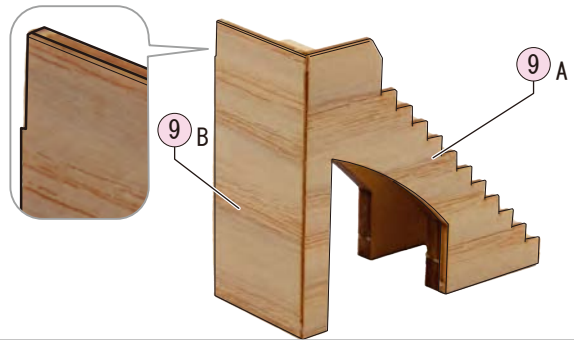
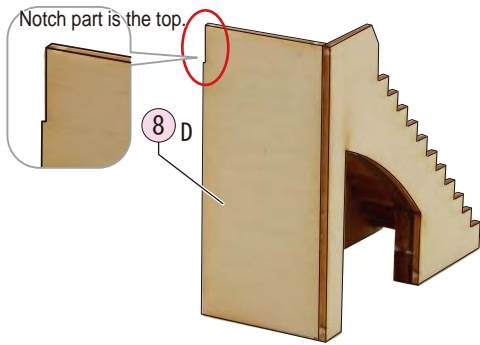
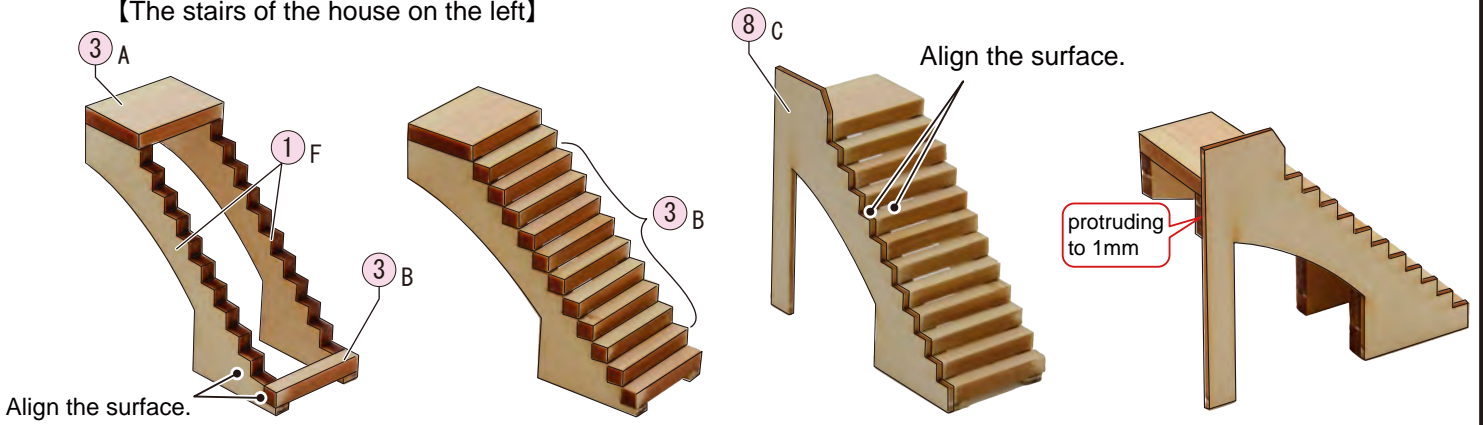

【Central stairs】

※There is one left.
Please use it for the flower bed.

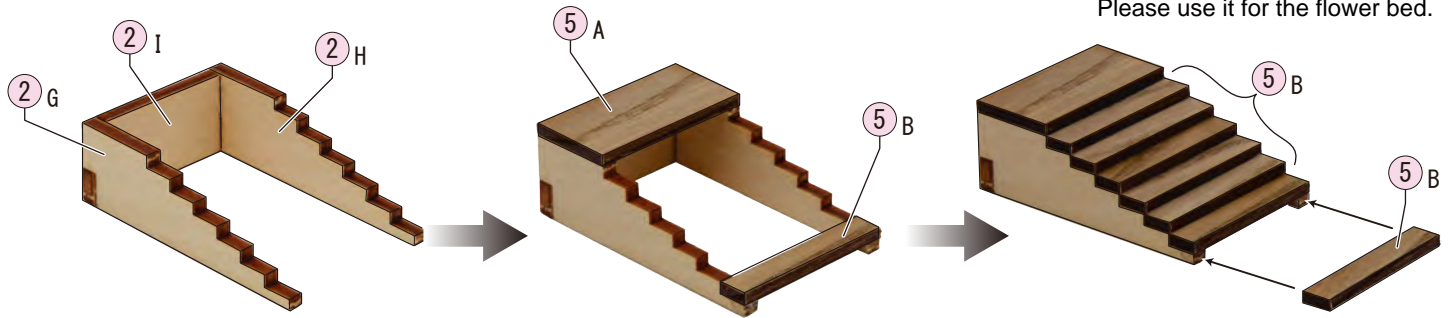

8

《Assembly of the clock tower 1》



●Stick ① A in ① B and glue them.

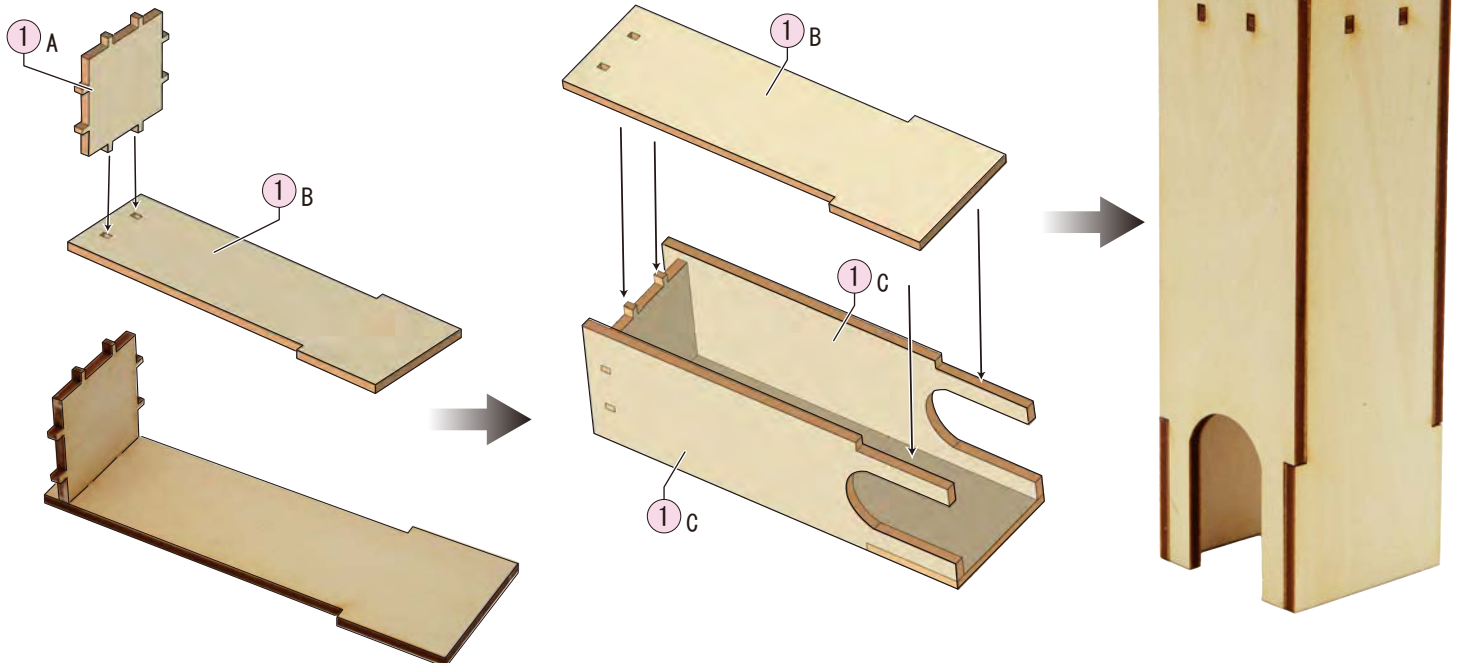

9

《Assembly of the clock tower 2》



【Front decoration】

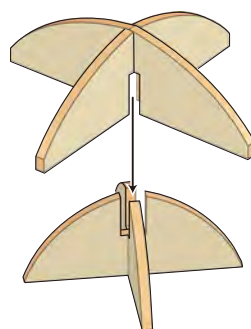
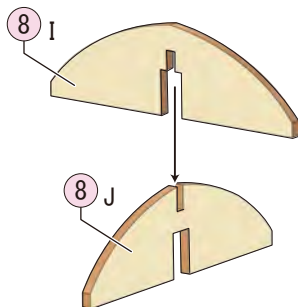
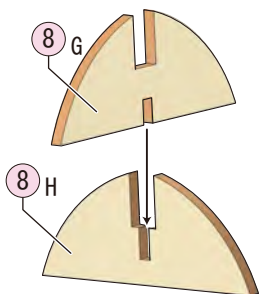
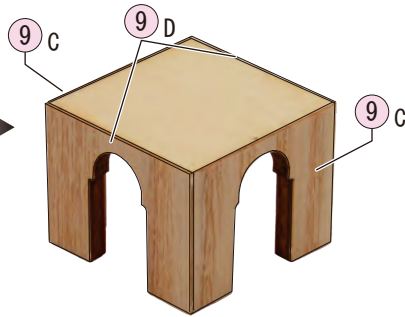
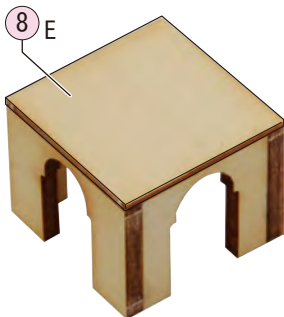
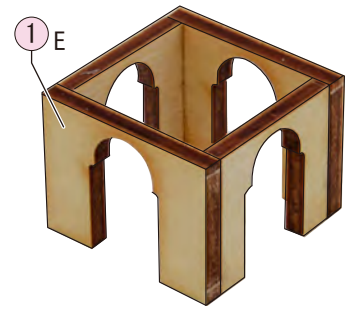
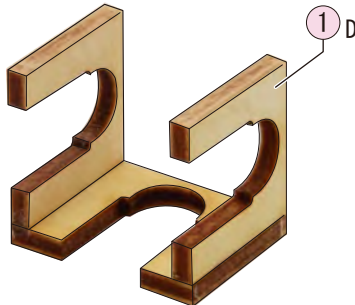
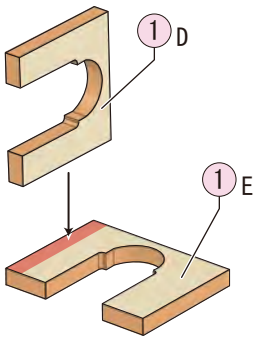
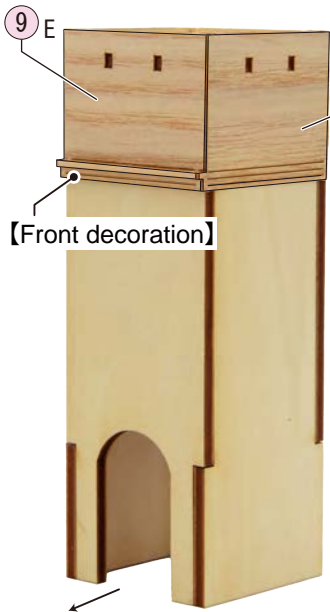
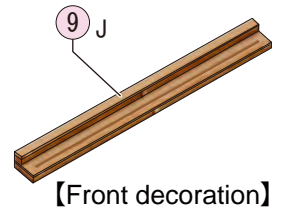
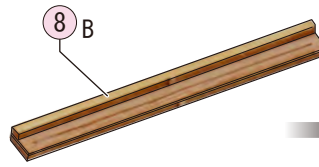
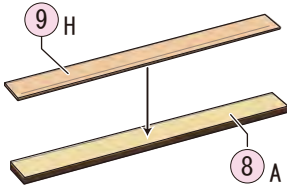

10

《Assembly of the clock tower 3》



- Assemble to the center and glue it.
- Put the brass nail in the vertex.

- Glue ⑪ A after making a bending tendency
Wetting the surface with a little water is easy to bend it.

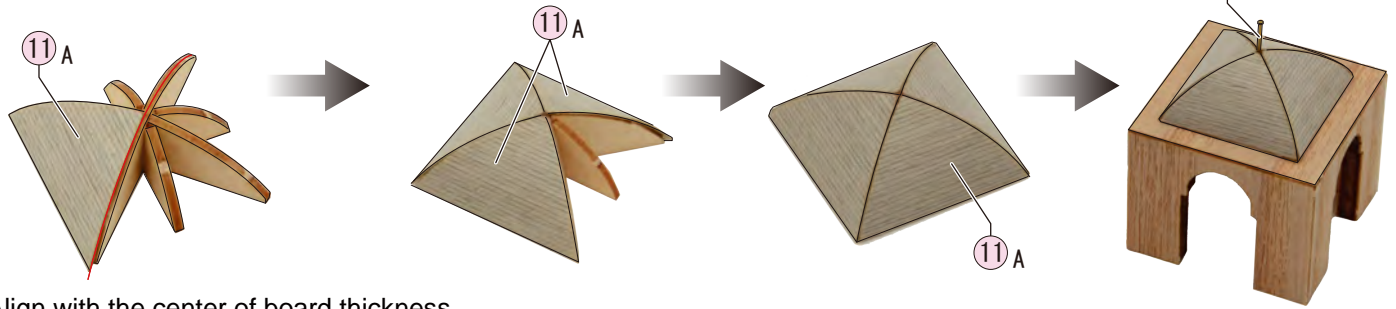

Align with the center of board thickness.

- Glue it to the center of the tower.



Front side

11

《Attach of the brick》



- Cut ⑨ M about 3 to 8mm with the cutterknife or scissors in advance.
- Glue them in a random on both sides of the tower wall.



What we want to express



In Italy, exterior wall is often used the plaster and the mortar on the brick or masonry, and the plaster are come off by the dilapidation. For the reason, There are the cityscape lined with the houses where masonry is exposed. Let's express masonry in various forms and colors.



It would be nice to put pieces of the same size together.

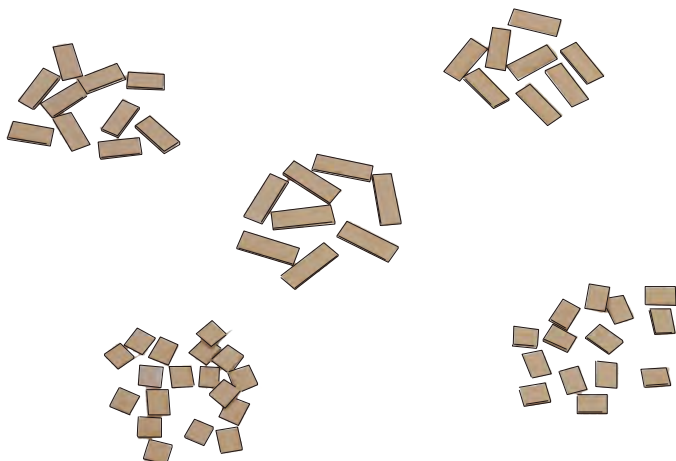

Cut them into small pieces and glue them on the arch.



12

«Attaching of bricks on the left and right side of the house»



In case Ceramic Stucco (see next section) is not used, first painting and then gluing bricks into the wall.

● As same as the attachment of the tower brick, cut ⑨ M ⑩ C ⑪ B ⑫ D to the length about 3 to 8mm in advance and glue them in a random.

【Attaching of bricks on the right side of the house】

⑨ M
⑩ C
⑪ B
⑫ D

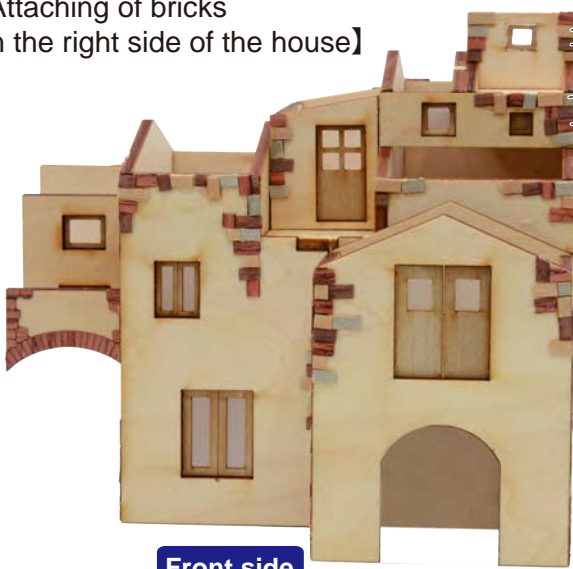

Front side



Right side

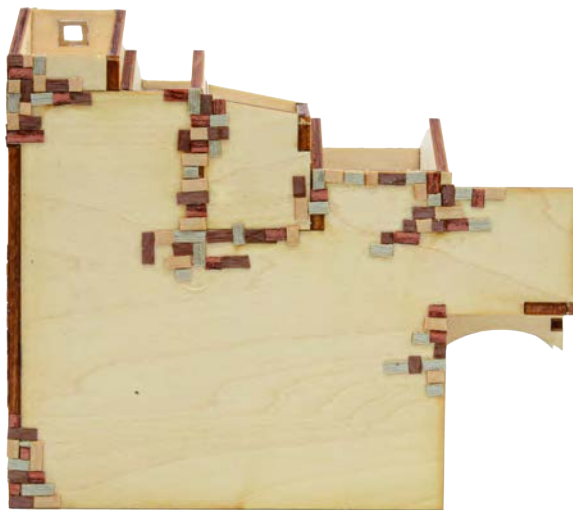

Back side



Left side

【Attaching of bricks on the left side of the house】



13

《Painting for exterior wall》



What we want to express



In Italy, where lime stone is abundant, exterior walls are made of plaster or mortar over stone bricks or masonry. Let's use the ceramic stucco to express the situation that plaster are come off, masonry is exposed.

- Using the optional ceramic stucco. Lightly paint little by little using painting knife (small knife).



A little on the masonry part gives a realistic feeling. If you get a lot of it, wipe it off immediately.



Liquitex Ceramic Stucco (an optional extra)

【Tower】



Painting on the left and right side of the house

- Mix the ceramic stucco and water-based acrylic paint of the color you like, lightly paint little by little.



In the case the ceramic stucco overflowed, remove them painting knife and sticks.

This model is mixed in the following the proportion.

色	Ceramic Stucco	Titanium white	Yellow oxide
割合	10	3	1



【Left side house】



Actual images

Yellow, brown, pink, orange, and many other colors.



If you are concerned about surface irregularities, please sand lightly with coarse sandpaper (#120) after drying thoroughly

Painted with the uncolored ceramic stucco.

【Right side house】

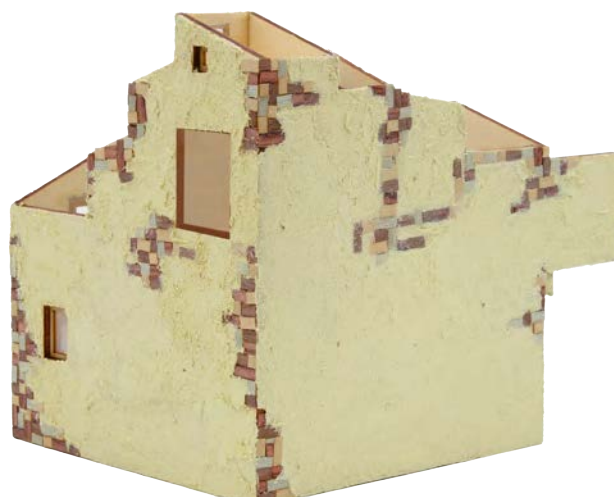

14

《Attach the tile of the left side house》

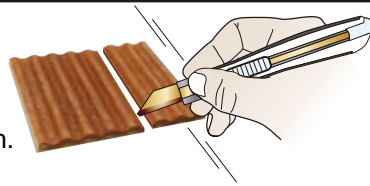

- Glue a piece of roof tile (18) and a piece cut to 20mm. Both ends are the mountain.
- *When cutting, cut several times with weak force.

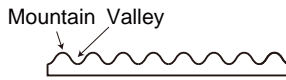

Special oil stain by woodyjoe
 — How to use —
 Spread the oilstain with brush or sponge, and polish the surface with dry cloth in a minute.

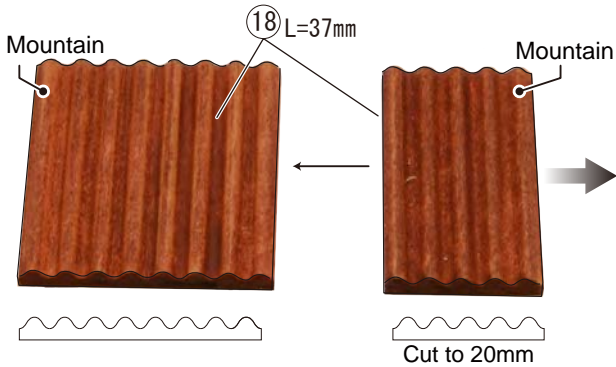

Oil stain paint



*Attach 2pieces

- (19) Restrict attaching parts of the ridge tile and make flat.

- Glue roof tile to the right side house.

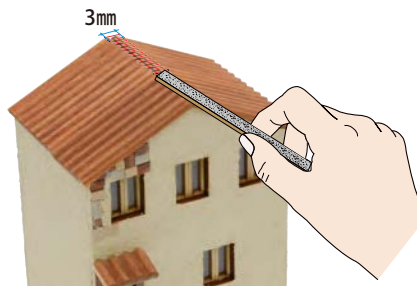

- Restrict diagonally the adhesive surface attaching the exterior wall.

Side view



15

《Attach the door of the right side house》

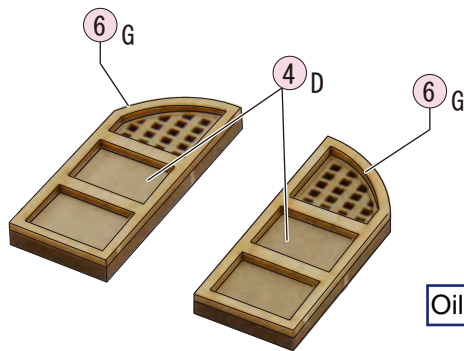

Oil stain paint



16

«Attach the tile of the right side house»



Mountain Valley

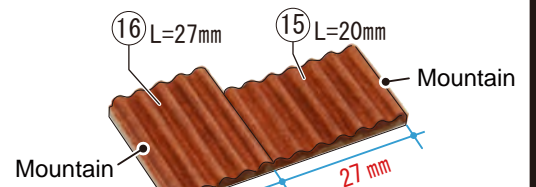

Connect and glue the roof tile, and make the length 50mm so that both ends are the mountain and the mountain.

Adjust them in the middle so that both ends are the mountain and the mountain.

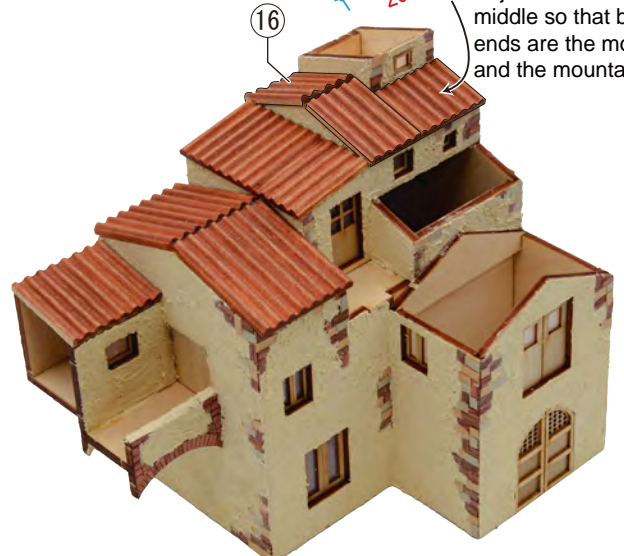
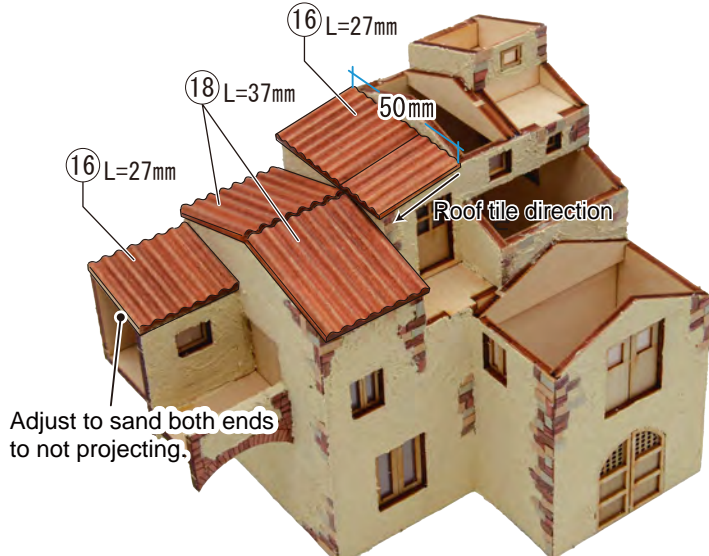

7 J Oil stain paint

※Both edges are projecting top and bottom evenly.

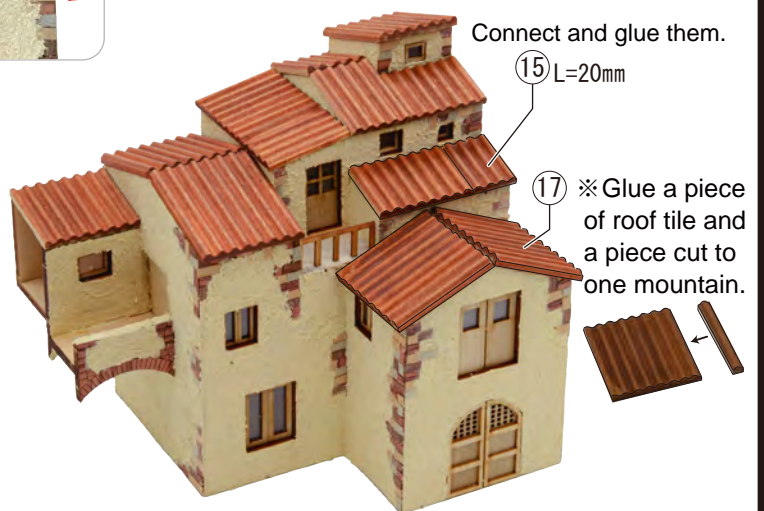
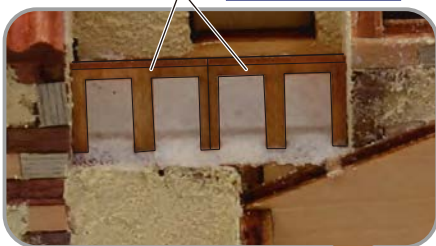

17

«Assemble the chimney»



[Chimney of the right house]

※2pairs

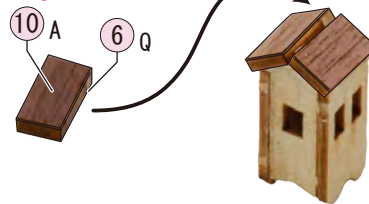
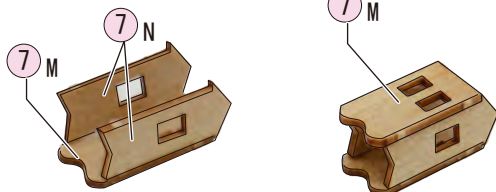

●Cut off according to the length and attach them. Slightly rounded to fit the roof shingles.

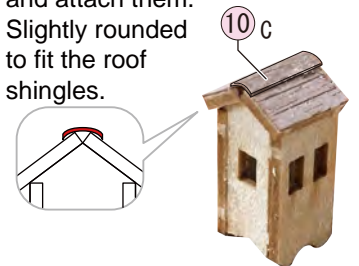

[Chimney of the left house]

※2pairs

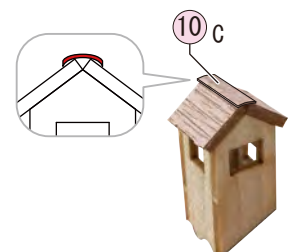
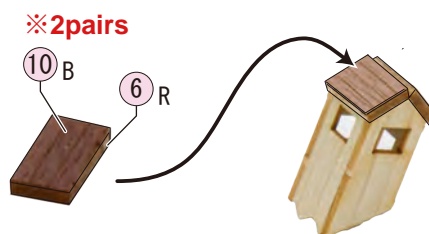
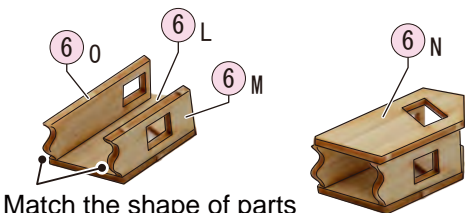

Match the shape of parts

18 《Assembly the ridge tile, chimney and window》

●Restrict attaching parts of the ridge tile and make flat.

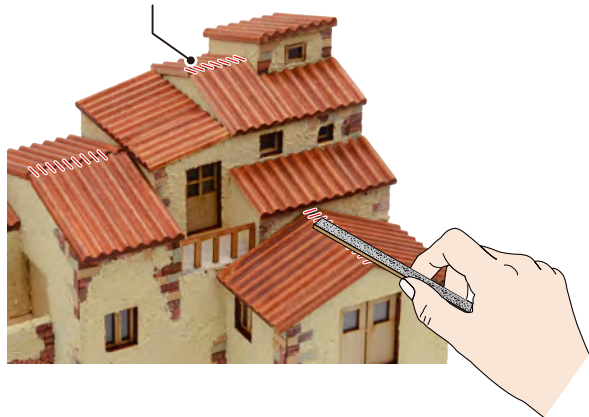

●Cut (19) along the length and glue it.

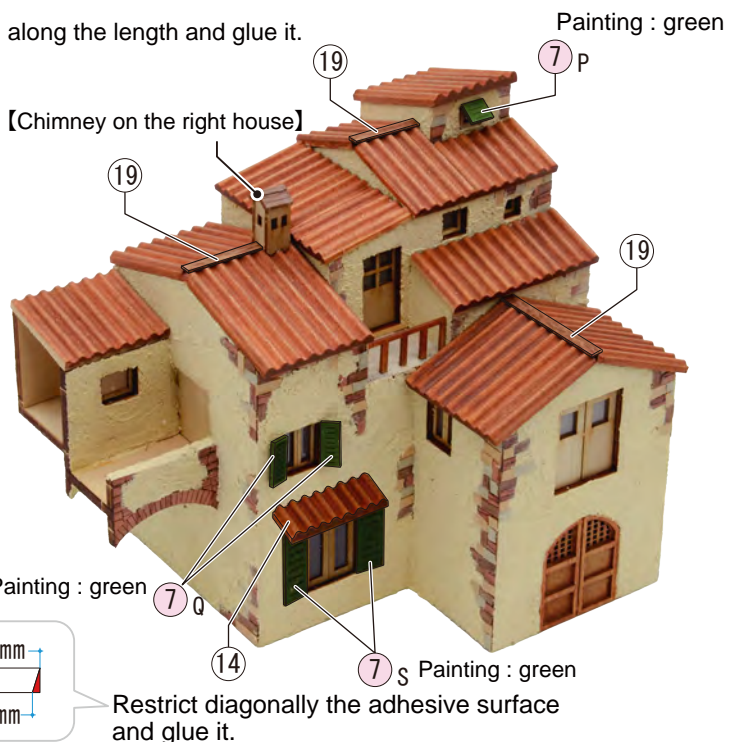

Front balcony

Slant
4 B ※Assemble 2pairs
6 H

Align the center

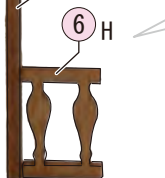

Oil stain paint

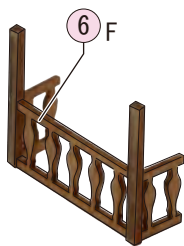

4 C The left-over parts use for the flower bed.

Back

Glue them equally.

Align the surface.

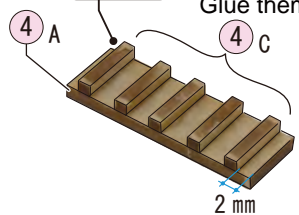

Turn over and glue them.

●Attach the wall to the front balcony.



Restrict diagonally the adhesive surface and glue it.

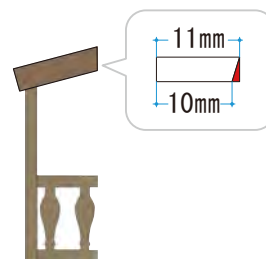

Balcony on the right side

Oil stain paint

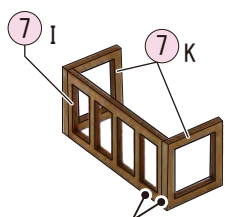

Align the surface.

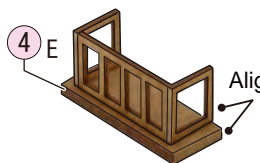

Align the surface.



7 R Painting : green

Balcony on the right side

●Glue it under the door flame.

19

《Attach the LED Chip light》



【Right house】

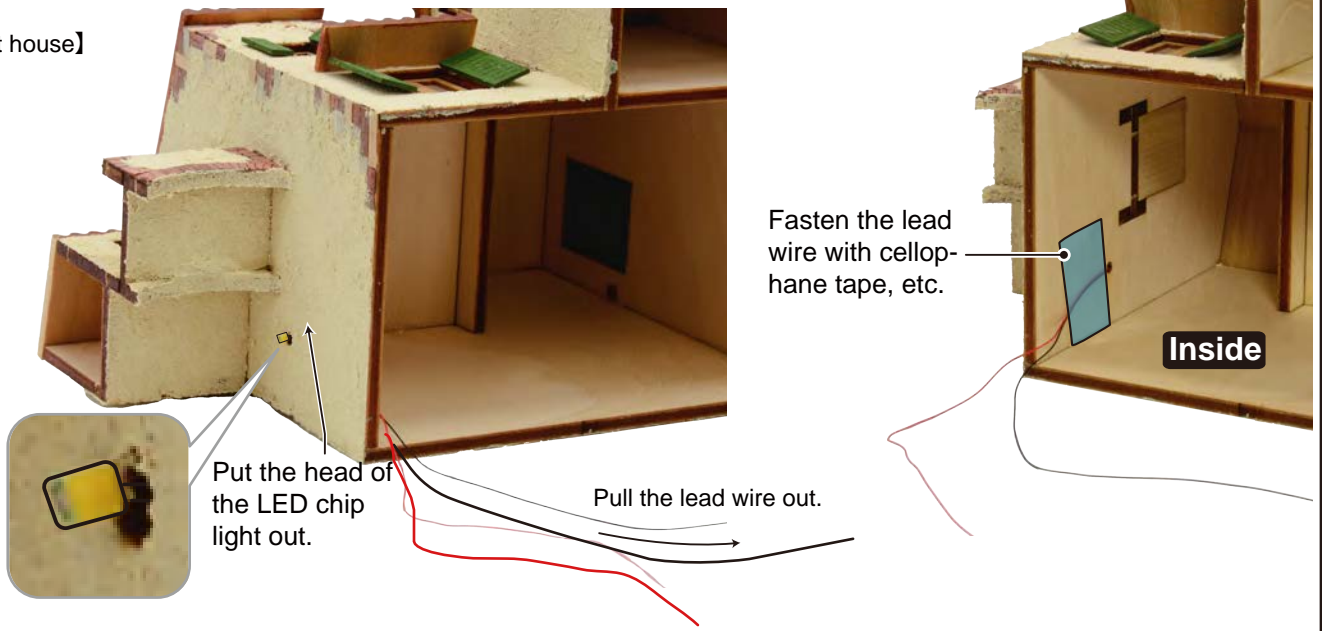

●Connect the lead wire from the house and the button battery holder.

※Twist the lead wire tightly and wrap the tape or the adhesive tape around them.

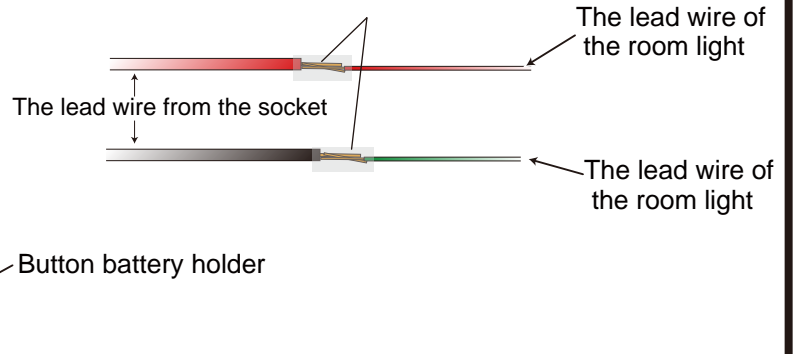

Cut off according to the length.

●Cut out from paper of the clothes and glue it to the rope.



Glue it to the center of window frame.



【Chimney on the left house】

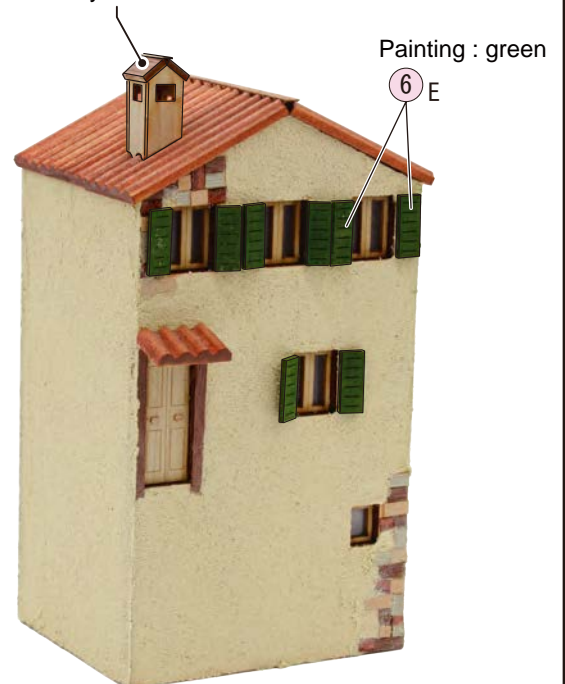

20

《Assemble the flower》



● Cut ④ C in half

It can neatly cut the stick by repeatedly turning the stick while pressing the cutter blade.

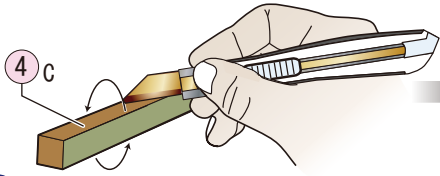

Point

Enjoy to glue the flower into the various place with using the left-over parts. Other colors are available and sold separately. Please make an inquiry about it.

● Glue the stick into the stairs, and glue land sponges for grass on the stick. Glue red sponges on them.
※ In the case of the large sponges, please use them cut to the small size.

● Glue the stairs in front of the left house.

Land sponges for grass

Land sponges for red flower

Pink and white flower

④ C

Align the surface.

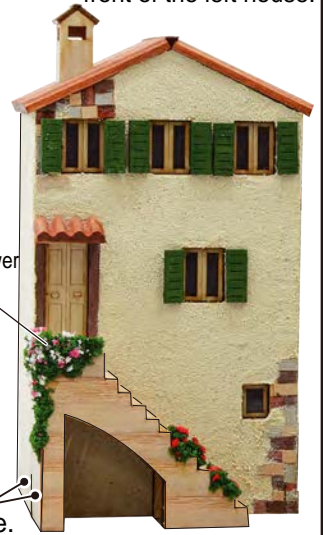

● Glue ⑨ into ⑬ plate of pedestal.

Paper for the stone wall ⑨

⚠ High moisture content causes deformation and warping.

Red flower ⑬ Plate of pedestal



It is okay to painting your favorite color.

● Place the house on the plate of pedestal and it will be completed.

⑤ C



Left side house

Clock tower

Right side house

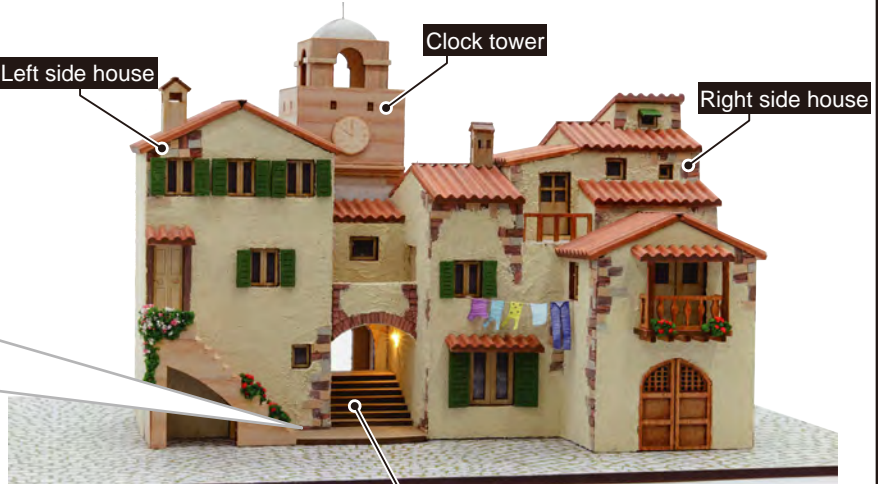

Stairs

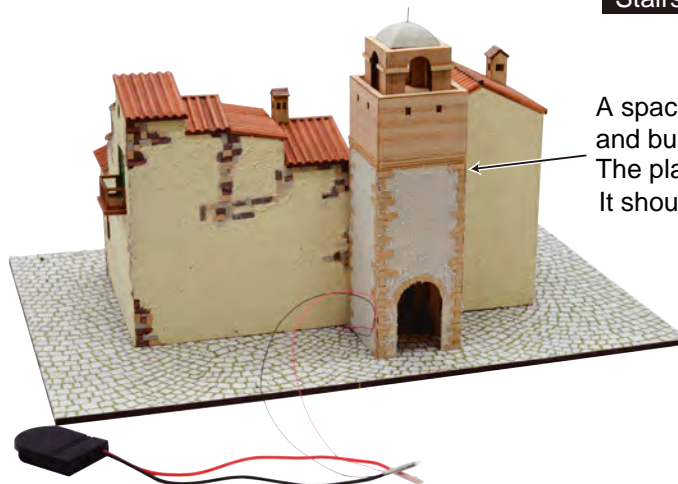

A space is created between the tower and buildings. The place putting the tower is free. It should put it the place that you like.