

東海道五十三次

日本橋

NIHONBASHI

PARTS LIST

| Part No | Name of part | QTY | Part No | Name of part | QTY |
|---------|---------------------------------|-----|---------|--------------------------------------|-----|
| 1 | Base A - L | 1 | 11 | Round column $\phi 3 \times 19$ | 6 |
| 2 | Bridge girder, Others A - F | 1 | 12 | Round column $\phi 3 \times 21$ | 9 |
| 3 | Bridge framework A - D | 1 | 13 | Bar material 1.5x1.5x150 | 1 |
| 4 | Handrail, Others A - G | 1 | 14 | Decoration base | 1 |
| 5 | Bridge plank, Others A - I | 1 | 15 | Frame of the decoration base (Long) | 2 |
| 6 | Bridge plank, Others A - G | 1 | 16 | Frame of the decoration base (Short) | 2 |
| 7 | Stone wall A - D | 1 | 1 | Ornamental caps | 10 |
| 8 | Stone wall A - C | 1 | | Powder: Yellow ochre | 1 |
| 9 | Round bar $\phi 2 \times 150$ | 1 | | Cherry trees | 2 |
| 10 | Round column $\phi 3 \times 16$ | 6 | | | |

● Laser-cut parts

● Other parts

Paints for use



X-4 Blue



X-2 White



X-22 Clear

Gloss varnish



Liquitex:
Gloss polymer
medium

< After-sales services >

If some of the parts are missing or damaged during assembly, please contact us by postcards, fax or e-mail, with clear description of necessary information including the name of product, the name of requested parts, number of the parts, requested quantity, your name, address, email address and telephone number.



CAUTION

Read before assembly

- This is an assembly model. Please read the assembling instructions carefully before beginning assembling.
- Tear and discard the plastic bags contain parts after taking out the parts inside since the plastic bags may cause suffocation if small children place the bags over their head or swallow those.
- Please sand the wood parts neatly with a sandpaper or the like, and dispose the wastes from polishing in a rubbish bin. Please be careful not to get injured, as they are easily broken.
- Some parts have sharp edges. Please do not use them for any other purposes. Take extra cautions if you have small children.
- Some parts are small. Please do not swallow them by mistake. Take extra cautions if you have small children. Accidental ingestion may cause suffocation.
- You may need to use nippers, knives and files for assembly of parts. Careless handling may cause injuries by the tool edges. For children younger than 12 old, parents or a guardian must attend and carry out handling the tools.
- Please pay attention to the following tips for using adhesives and paints:
 - Do not use them in an enclosed room. There is a danger of intoxication.
 - Never use them near the source of flame. There is a danger of ignition.
 - Do not put cement or paint in your mouth, eyes. If ingested or taken by mistake, please wash away with a large amount of water immediately and consult a doctor.
- Please note the parts are subject to change without prior notice.



Oya691 Suruga ward, Shizuoka, 422-8017
E-MAIL : info@woodyjoe.com

Prepare the necessary tools for assembly.

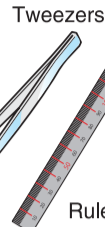

Ruler

Paste sandpaper on a small round bar or chopsticks to make rubbing works easier.

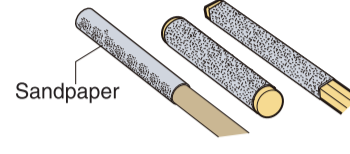

Sandpaper

[Woodworking bond]



[Instant glue for woodwork]



1 <Assemble the bridge>

- Cut off the laser-cut parts by cutting the connecting parts from the surface or back side.
- Glue round columns perpendicularly with Jig ① L.

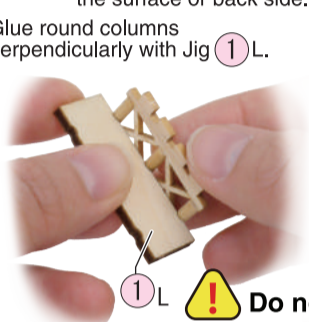
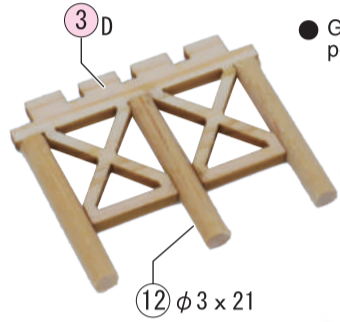

Do not glue ① L

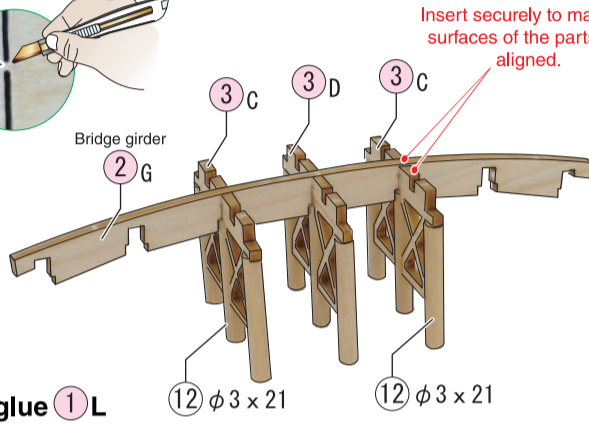

Insert securely to make all surfaces of the parts are aligned.

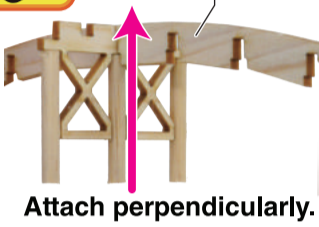

Attach perpendicularly.

Do not glue ① L

- Use the jig ① L to decide the gaps between the columns and attach the columns perpendicularly.

Do not glue ① L

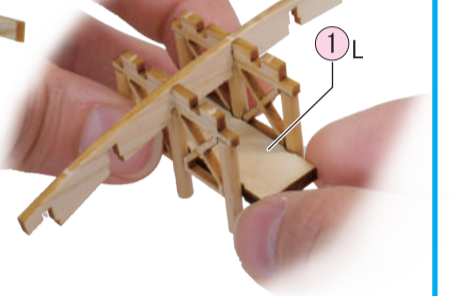

- Repeat the same for ③ A & B: Attach round columns and then attach them perpendicularly to the bridge girder.

Use a jig to keep the intervals between the columns even.

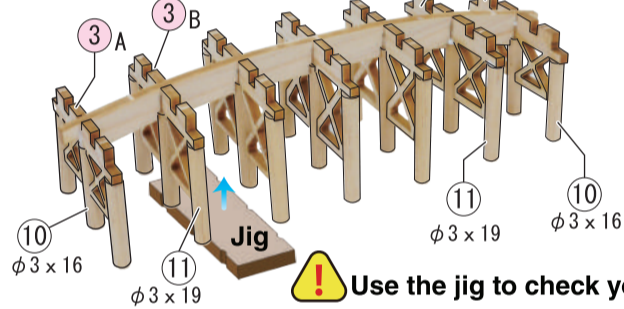

Use the jig to check your eye measuring.

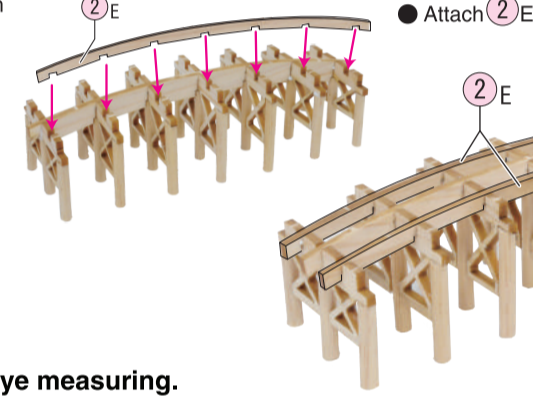

Attach ② E

2 <Attach the bridge planks>

- Fix the bridge plank ⑥ A by centering on the bridge. Attach the plank. Do NOT take apart the parts.

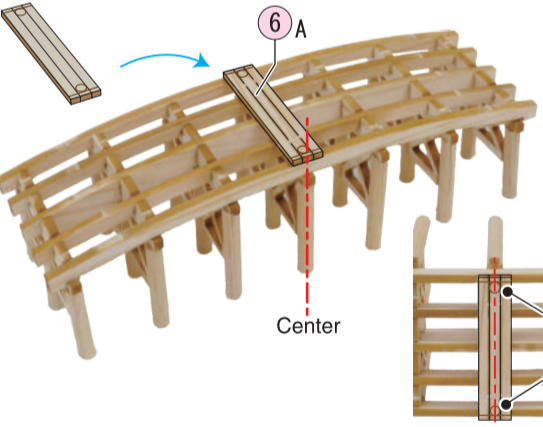

Center

The view of the bridge from top.

- ⑨ Attach the round bars on the circle marks.

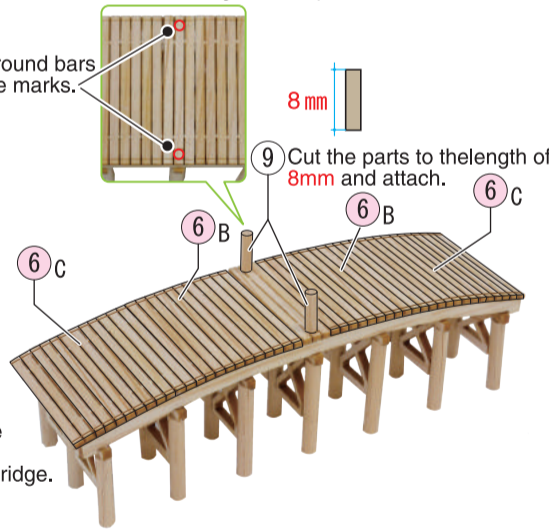

8mm

- ⑨ Cut the parts to the length of 8mm and attach.

Align the circle marks on the center of the bridge.

3 <Assemble the handrails>

The view of the bridge from top.

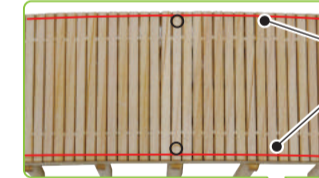

Attach the handrails inside the line.

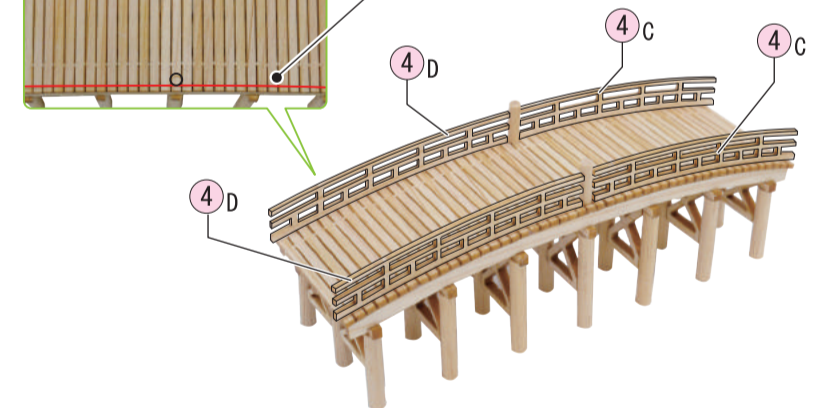

4 <Assemble the base (large)>

※ Roughly shave with cutter knife, etc. and adjust with sandpaper.

- Attach to the wall.

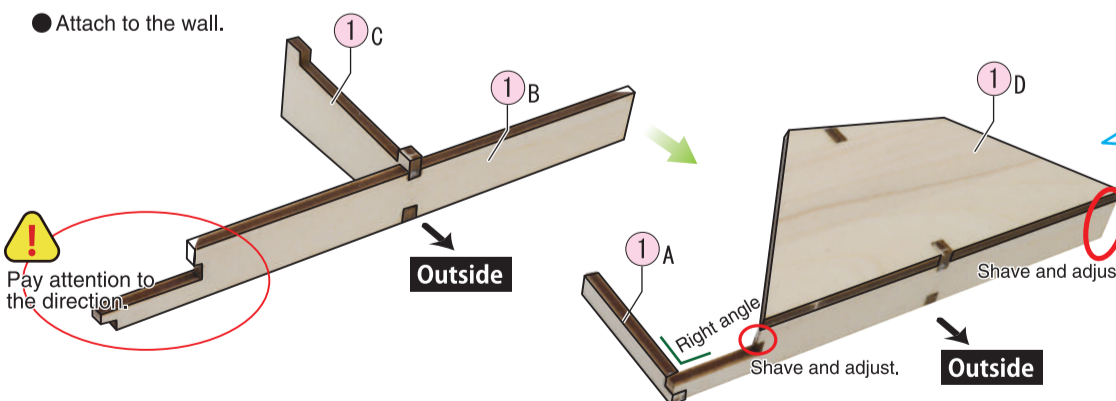

Pay attention to the direction.

Outside

Shave and adjust.

Outside



- Shave ① B to match the angle of ① D.

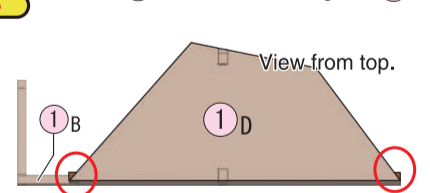

View from top.

※ Cut each corners with a cutter knife, and rub those with sandpaper to make smoother.



Inside

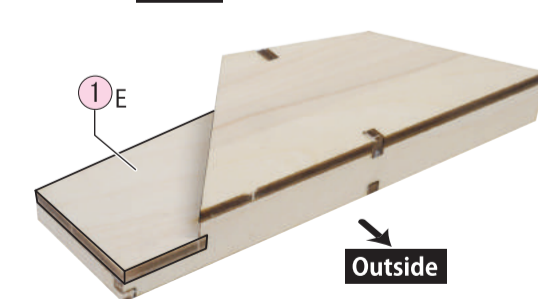

Outside

- Shave the corner to fit.

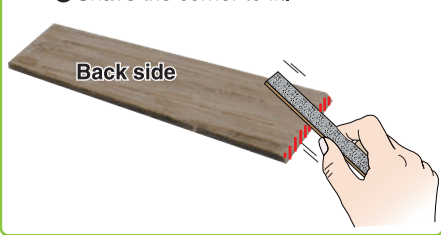

Back side

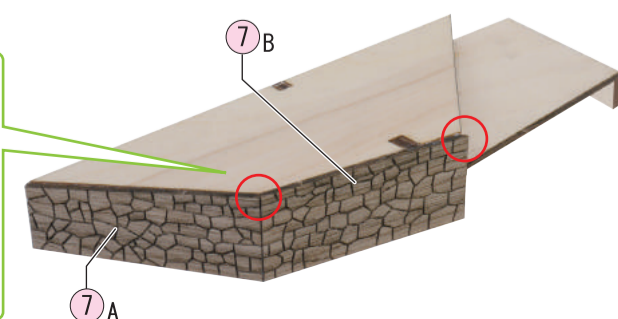

7 A

7 B

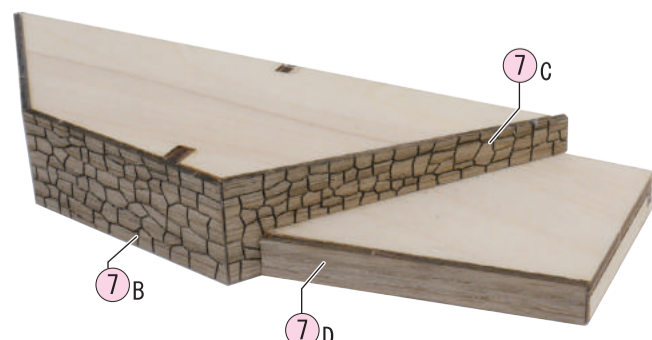

7 B

7 C

7 D

5 <Assemble the base (small)>

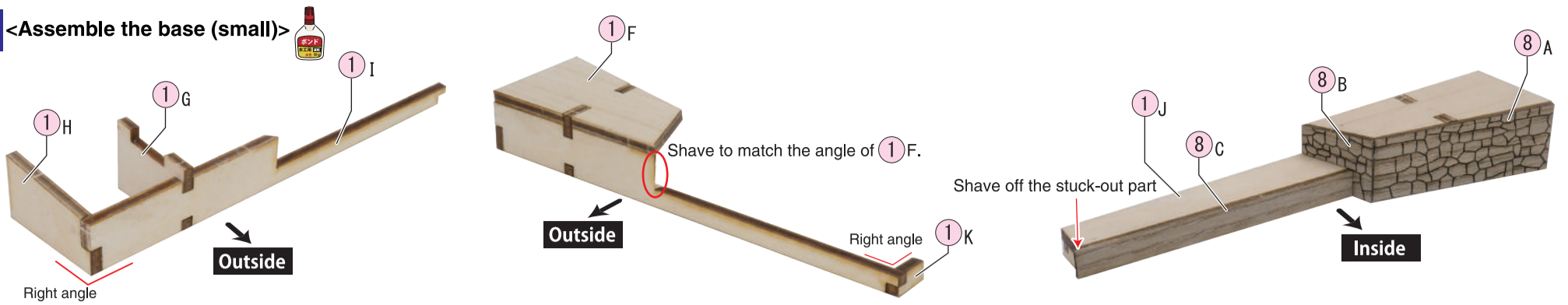

6 <Assemble the frame of the decoration base, attach the base and the bridge>

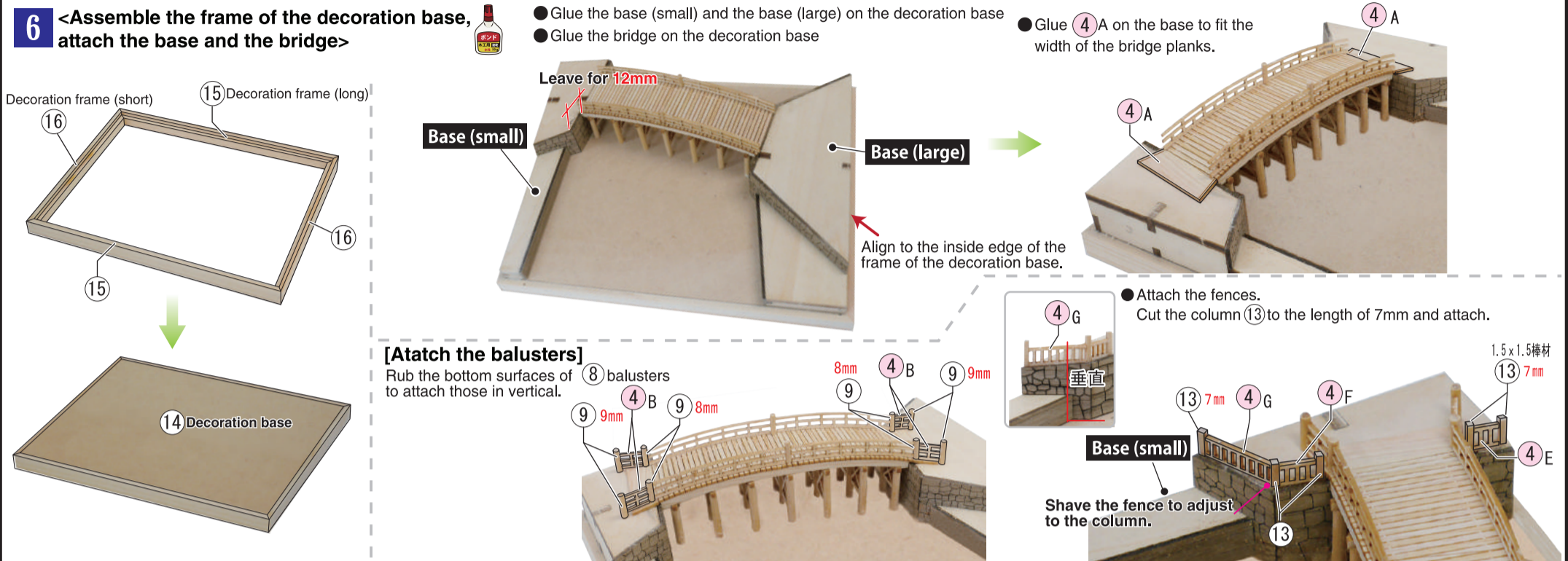

7 <Diorama set-up>

- Apply woodworking bond thickly over the entire area and spread yellow ochre powder. Press the whole surface lightly and shake down the extra powder. Make it completely dried.
- Pale green powders (sold separately) are used.



- Paint the whole center part with pale blue made thinner with the clear paint and dry.
- Paint the center with dark blue made thinner with the clear paint over it, and change to the pale blue paint made thinner with the clear paint as approaching the edge.
- Apply the clear paint only around the edge.

※ Gradate the boundary of colors with the Clear paint to make natural gradation.



First time

- Once the paint dries completely, apply Gloss Polymer Medium. (Applying too thick may cause cracks, so apply in thin twice to three times.)

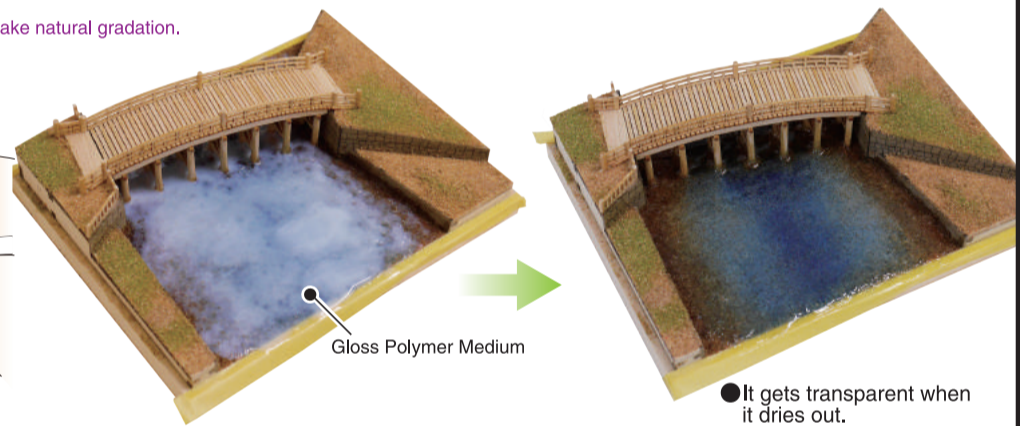

8 <Assemble the boats>

- Put 5F & H in the frames of boats and glue. (Align the bottom faces)

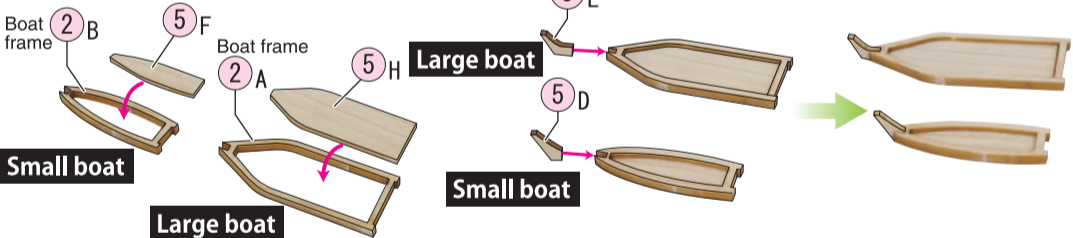

Second time

- Apply Gloss Polymer Medium and place the boats. Have each sailers to hold an oar 6F.

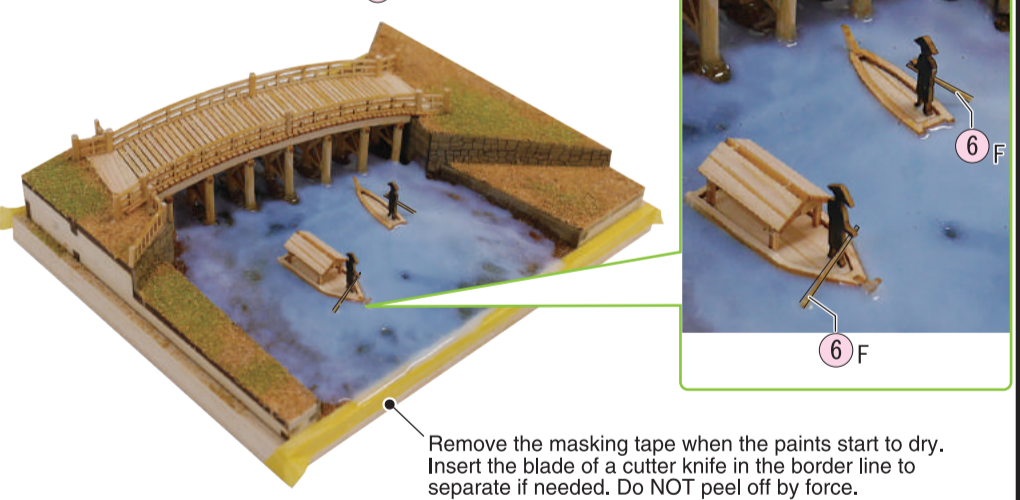

9 <Attach the cabin and the signboards.>

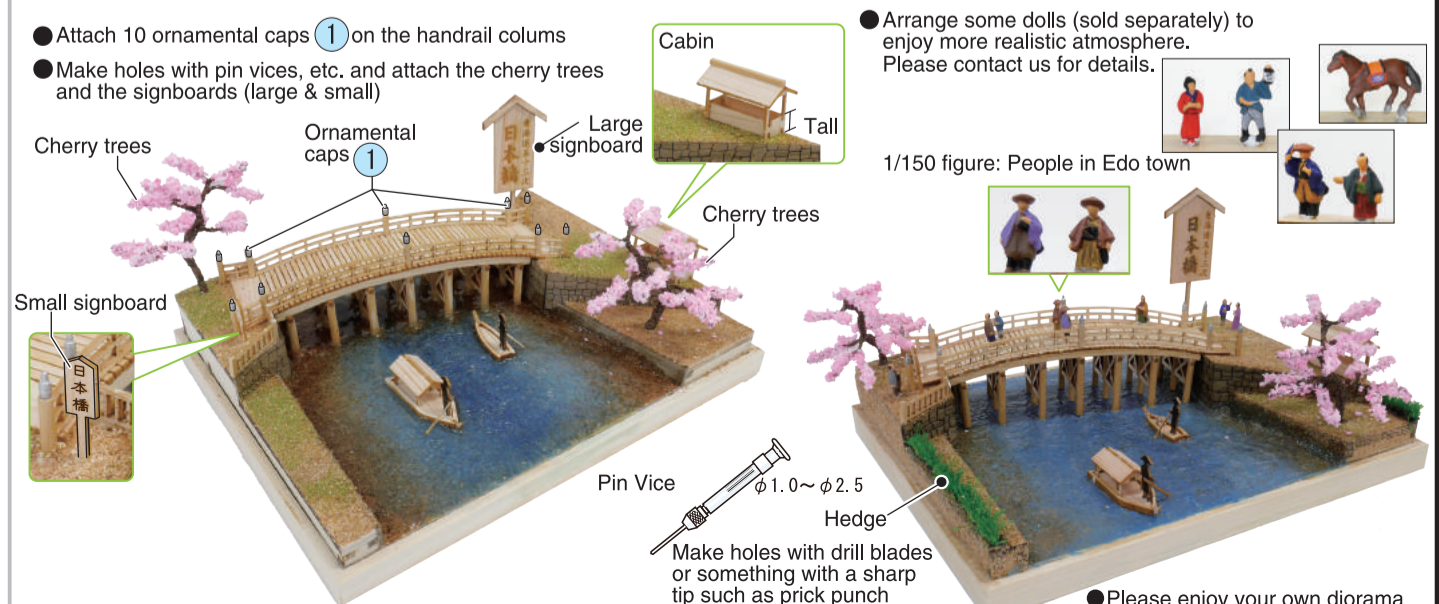
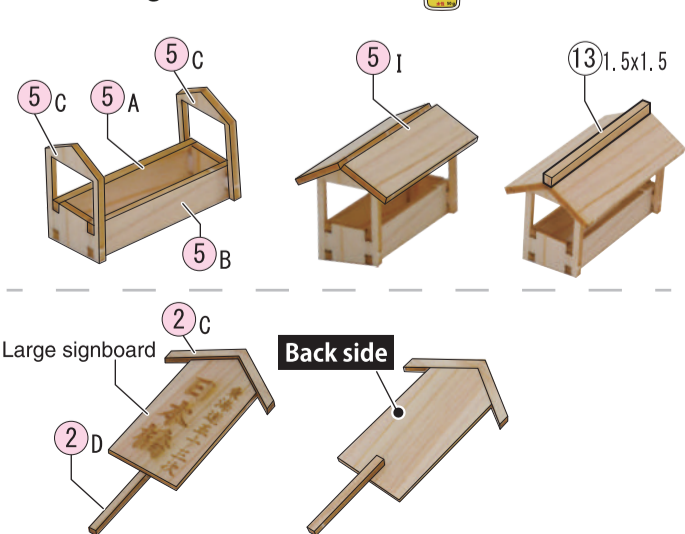

● Please enjoy your own diorama