

雷門

HALF TYPE

KAMINARIMON



CAUTION

Read before assembly

1. This is an assembly model. Please read the assembling instructions carefully before beginning assembling.
2. Tear and discard the plastic bags contain parts after taking out the parts inside since the plastic bags may cause suffocation if small children place the bags over their head or swallow those.
3. Please sand the wood parts neatly with a sandpaper or the like, and dispose the wastes from polishing in a rubbish bin. Please be careful not to get injured, as they are easily broken.
4. Some parts have sharp edges. Please do not use them for any other purposes. Take extra cautions if you have small children.
5. Some parts are small. Please do not swallow them by mistake. Take extra cautions if you have small children. Accidental ingestion may cause suffocation.
6. You may need to use nippers, knives and files for assembly of parts. Careless handling may cause injuries by the tool edges. For children younger than 12 old , parents or a guardian must attend and carry out handling the tools.
7. Please pay attention to the following tips for using adhesives and paints:
 - Do not use them in an enclosed room. There is a danger of intoxication.
 - Never use them near the source of flame. There is a danger of ignition.
 - Do not put cement or paint in your mouth, eyes. If ingested or taken by mistake, please wash away with a large amount of water immediately and consult a doctor."
8. Please note the parts are subject to change without prior notice.



WoodyJOE
ウッドジョー

Oya691 Suruga ward, Shizuoka, 422-8017

E-MAIL : info@woodyjoe.com

<<Part list>>

NUMBER	PART NAME	QTY		OTHER PARTS	QTY
1	Spandrel wall, Roof frame, Others 3mm plywood	1	16	Girder L=18	4
2	Rear wall, Lantern wall, Others 3mm plywood	1	17	Round column φ6x57.5	8
3	Stone floor 3mm plywood	1	18	Bar material 1x3x25	22
4	Frame of lantern 1mm cypress	1	19	Bar material 1x5x160	3
5	Frame of lantern 1mm cypress	1	20	Bar material 1.5x4x160	1
6	Low fence 1.5mm cypress	1	21	Decoration frame (long) 6x20x190	1
7	Gable board 1.5mm cypress	1	22	Decoration frame (short) 6x20x64	2
8	Ancon, Ridge tiles 1.5mm cypress	1	23	Battery box cover	1 set
9	Ogre-shaped gargoyle, Lattices and Others 1.5mm cypress	1	24	Wall paper, Lantern sheet	1 set
10	Decorations of gable Gold sticker	1	25	Lantern belt	2
11	Roof tiles L=68	4	26	Wind God (Fujin)	1 set
12	Eaves tiles L=3	4	27	Thunder God (Raijin)	1 set
13	Rafter L=12.5	4	28	Light bulb	1
14	Rafter L=18	4	29	Battery box	1
15	Rafter L=37	1			

[Woodworking bond]

Prepare the necessary tools for assembly

Cutter knife

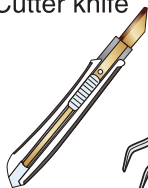

Tweezers



Scissors



Sandpaper

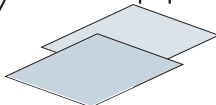

Double sided tape



- Paste sandpaper on a small round bar or chopsticks to make rubbing works easier.

Sandpaper

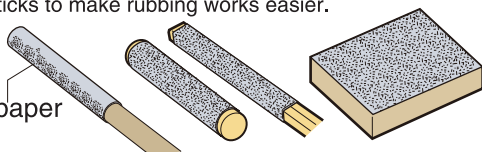

[Instant glue for woodworking]

- Use it when you want to fix the wood parts quickly. You can also use it to fix wood part and metal part together, and for other purposes.



<<Paint>> We recommend "Liquitex", high pigment concentration, easier to paint evenly. You don't need to dilute with water before use.

Locations of use	Wall	Fence lattice	Roof tiles / Other
Color	Red	Green	Grey
Liquitex	Pure red	Chromium oxide green	Neutral grey



Red



Green



Grey

1 <Assemble the spandrel walls 1>

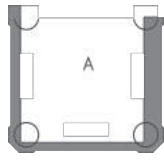

● Cut off the laser-cut parts by cutting the connecting parts from the surface or back side

Connecting part

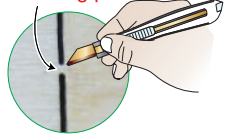

● Paint around the edges of ① A & B in grey.

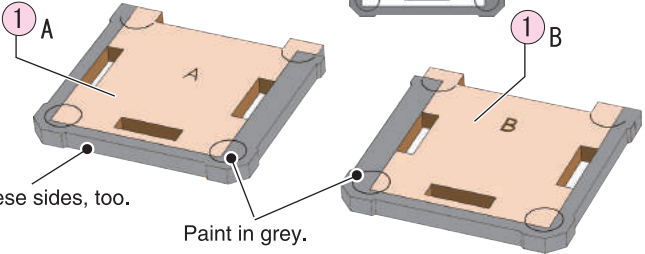

Paint these sides, too.

Paint in grey.

● Paint the surface of ① red, insert those parts in the holes and glue

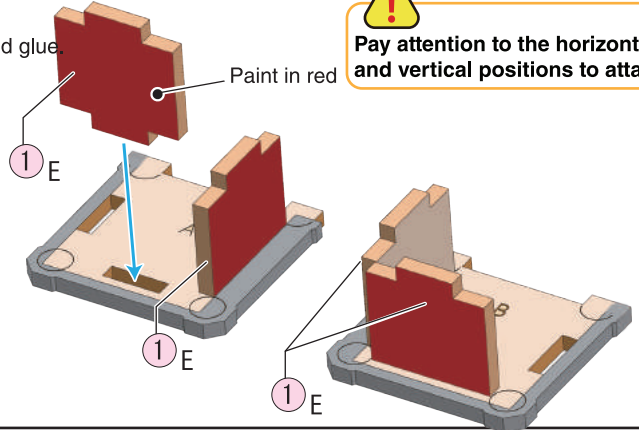

!
Pay attention to the horizontal and vertical positions to attach

2 <Assemble spandrel walls 2>



● Attach ① C & D and paint those in red.

※ A on top of A ① C

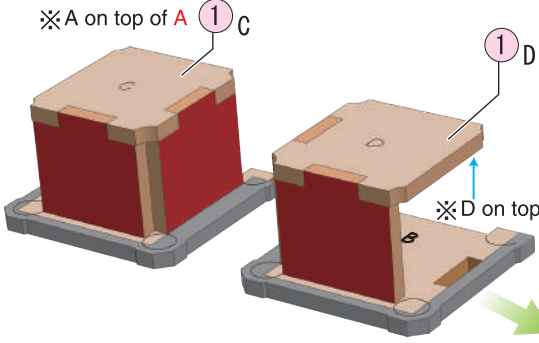

※ D on top of B

● Paint in red

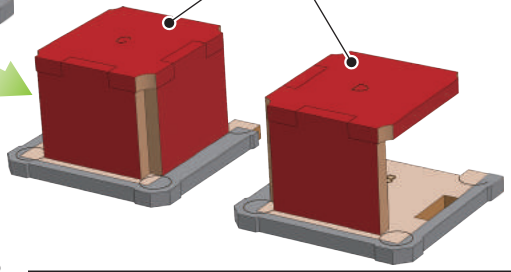

3 <Assemble the side walls>

※ Paint the back side, too

● Paint ① G & F in red

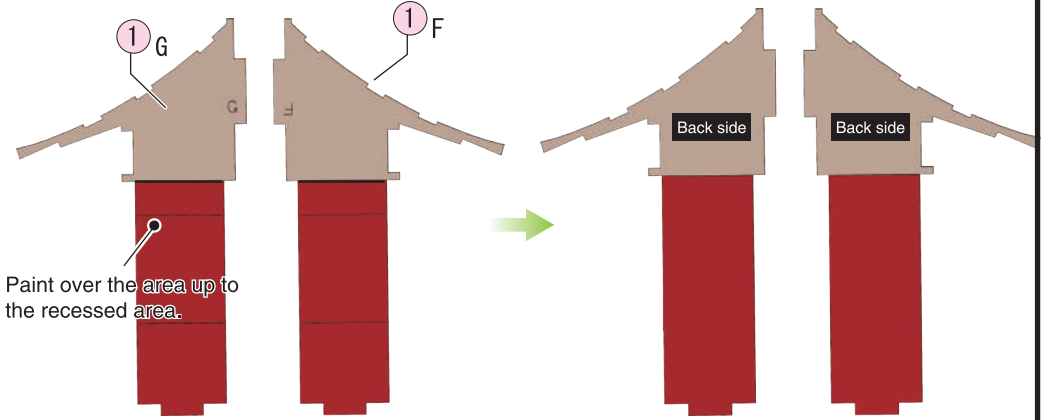

● Insert ① G & F in the holes of outer side and glue.

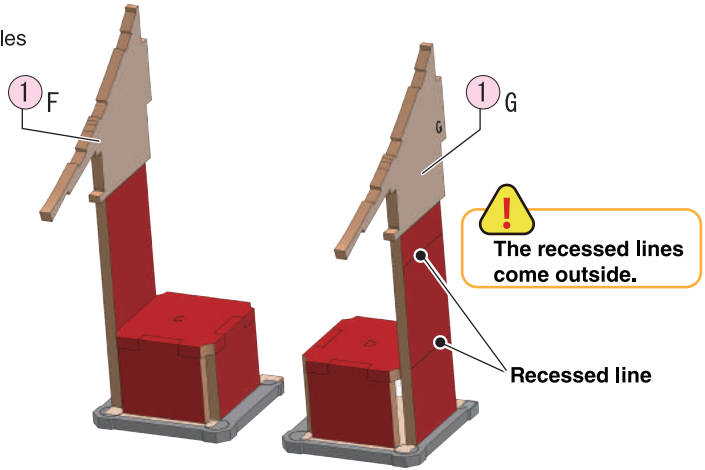

4 <Paint the back wall plate & Paste the wall paper>

※ Keep C after removing it

② B ● Paint in red

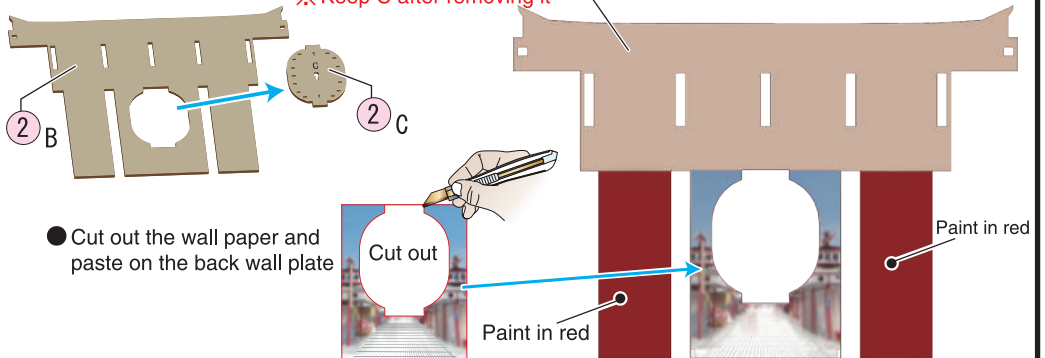

5 <Attach the walls>

- Attach 2 sets of the side walls on the back wall plate

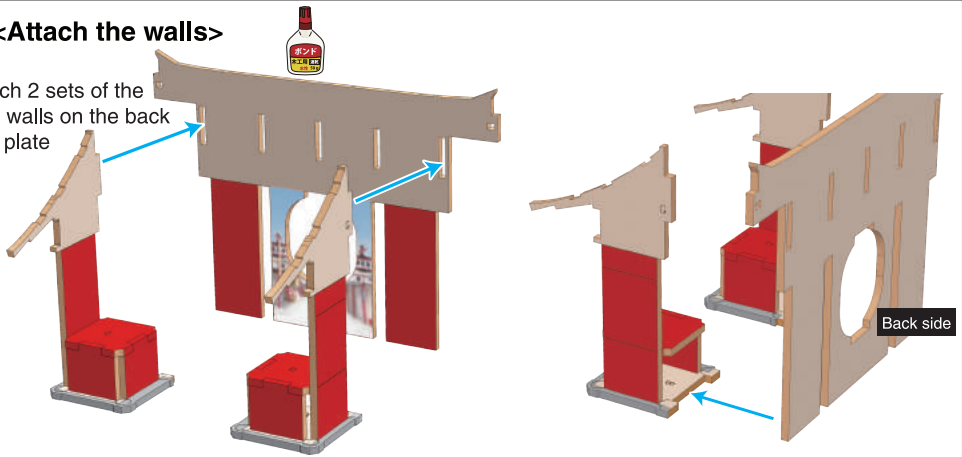

6 <Assemble the roof frames>

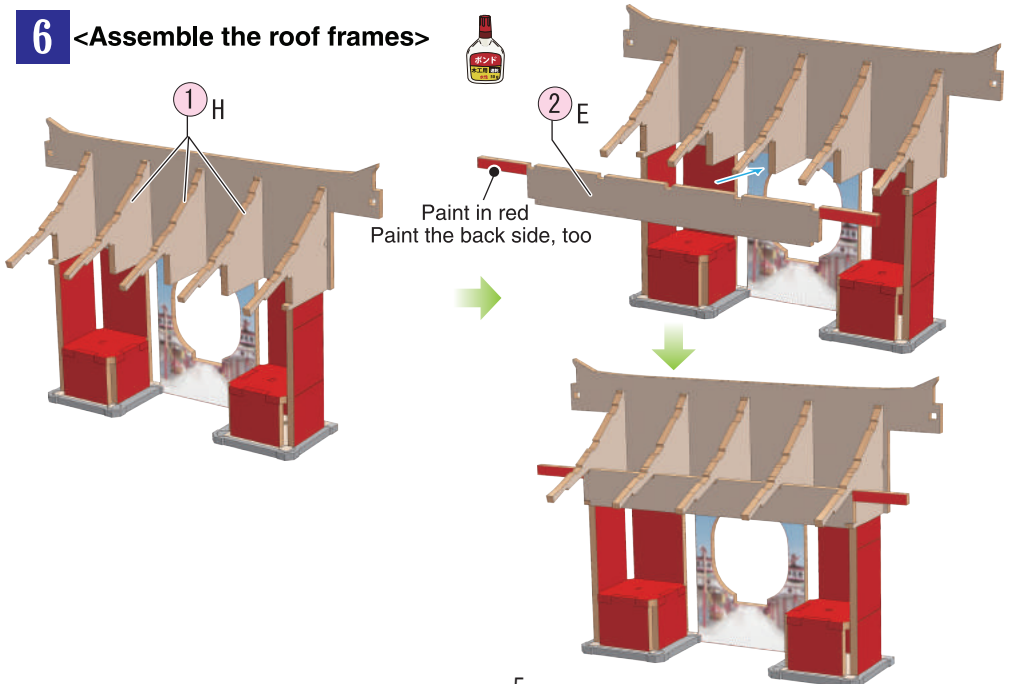

7 <Paint the columns, Paste the decorations and Attach>



- Paint (17) in red and paste the decoration for the column

※ **Make 8 sets**

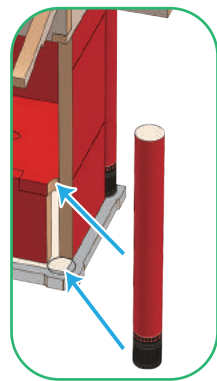
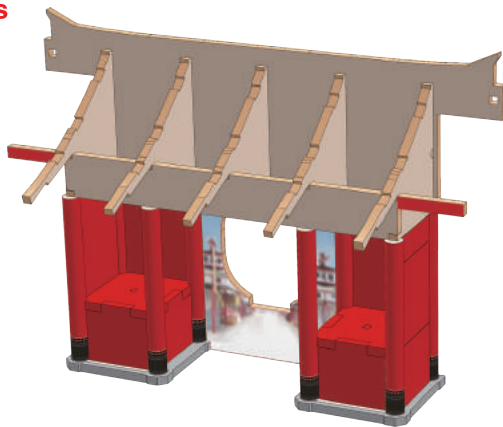
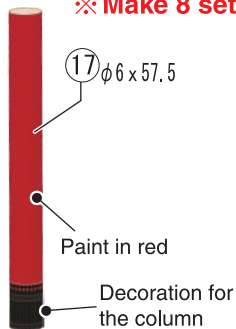

- Attach (1) J to the hole on the both sides.

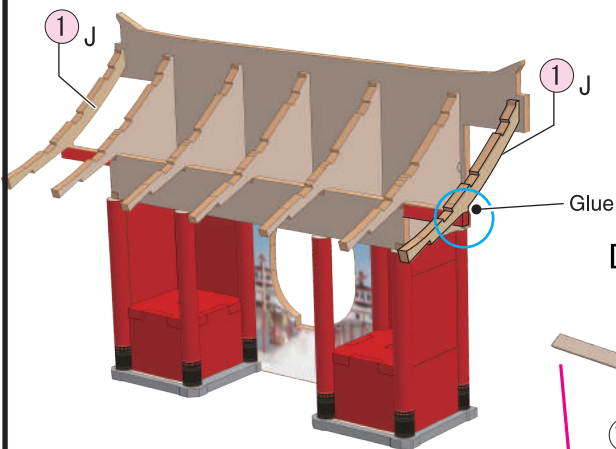

[Attach the base materials]

- Attach 3 bar materials (19) 1x5x160.

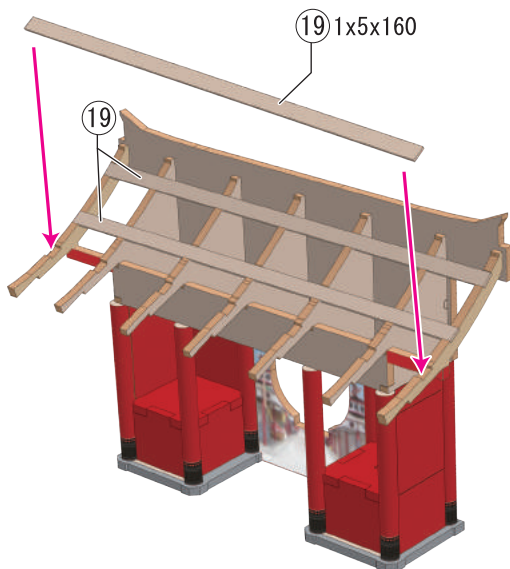

8 <Attach the bars and the lattices>

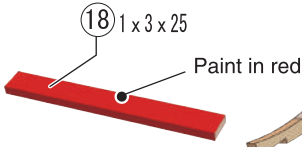

● Shave to adjust the length along with the columns

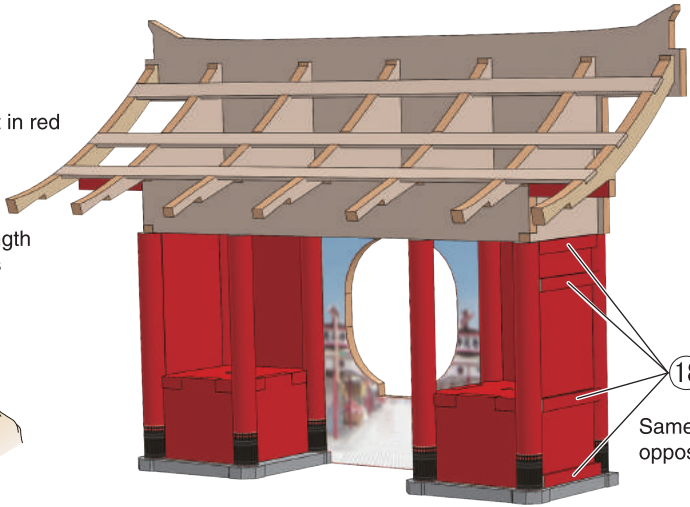
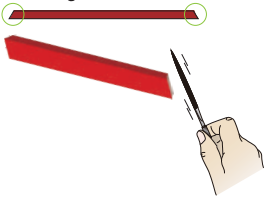

18
Same for the opposite side

[Assemble the lattices]

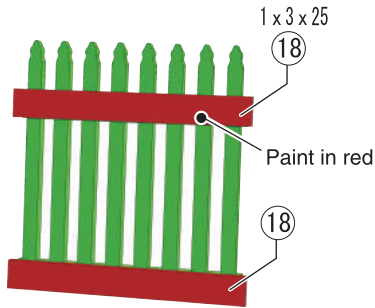
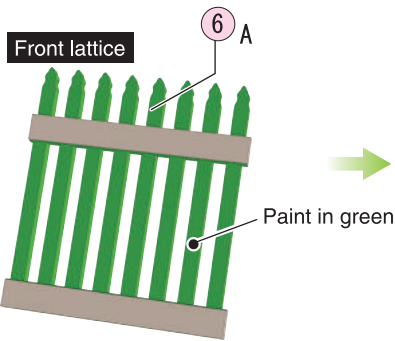

● Shave to adjust the length along with the columns

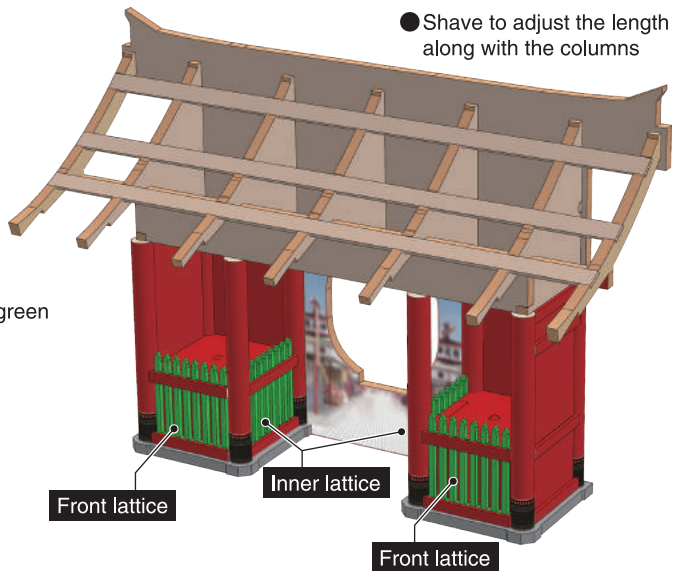
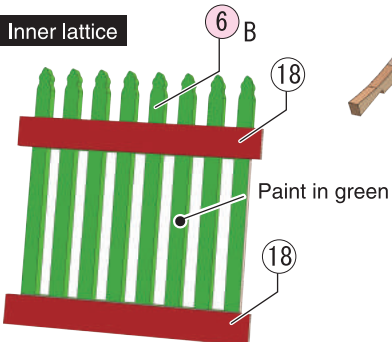

Front lattice

Inner lattice

Front lattice

9 <Assemble & attach top lattices>



● Paint the center in green

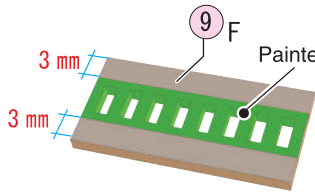

Inner lattice Make two sets

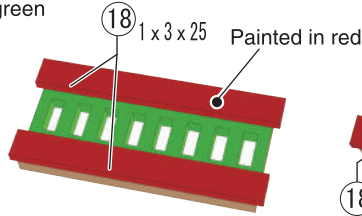

Front lattice Make two sets

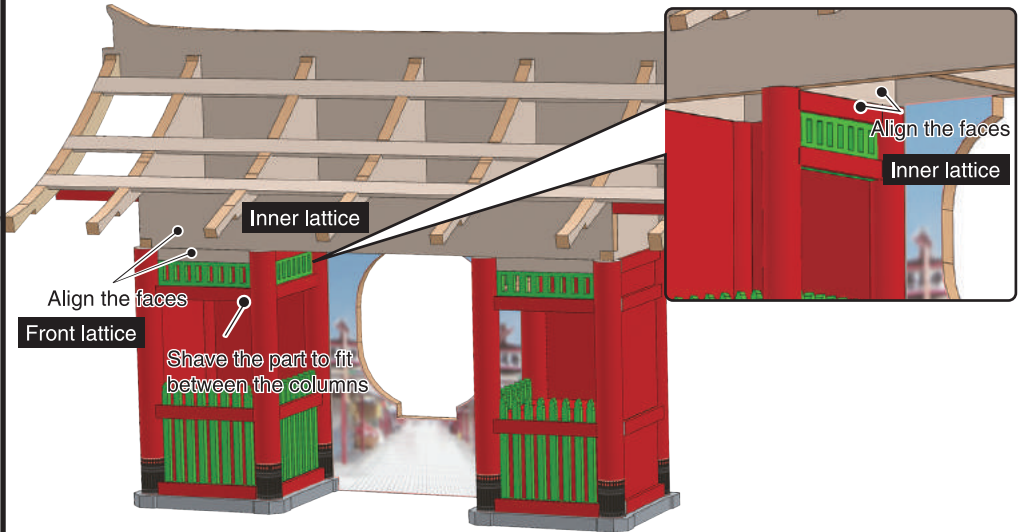
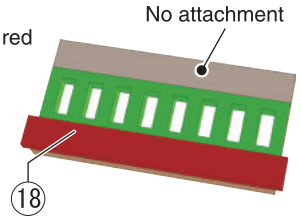

10 <Attach the ancon>

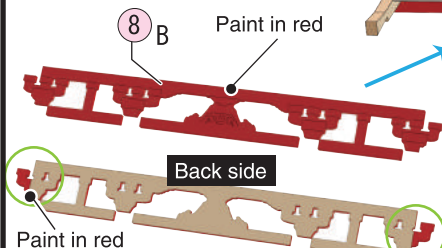

※ Paint the parts which can be viewed from the back side as well. Paint in red

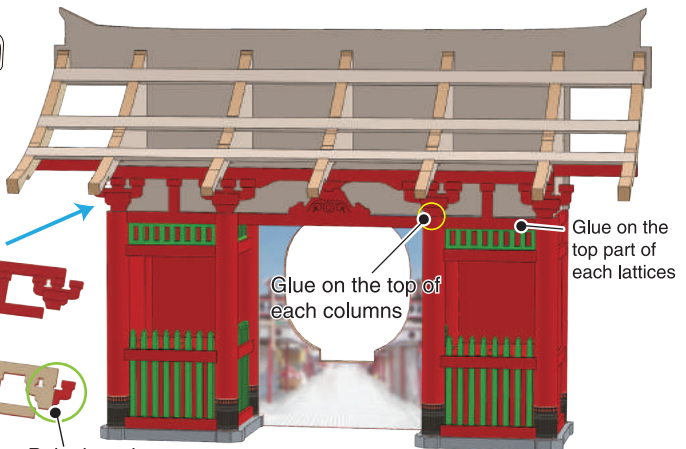

11 <Attach the third & the first sections of rafters>



● Cut out the rafter (15) L=37

● Insert the rafter from the front side up to the wall behind and glue.

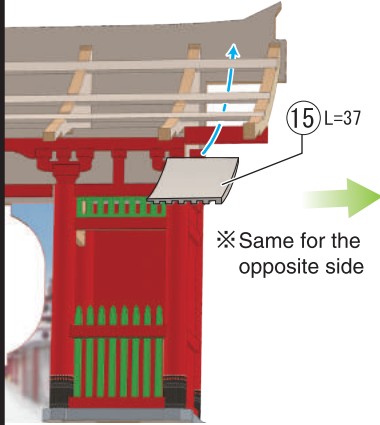
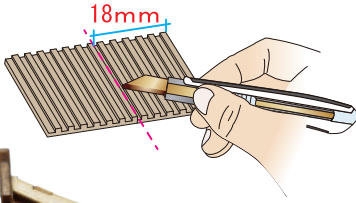

Glue it on the back side of the base materials

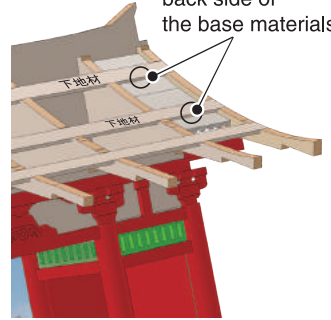

● Attach the rafter (13) L=12.5.

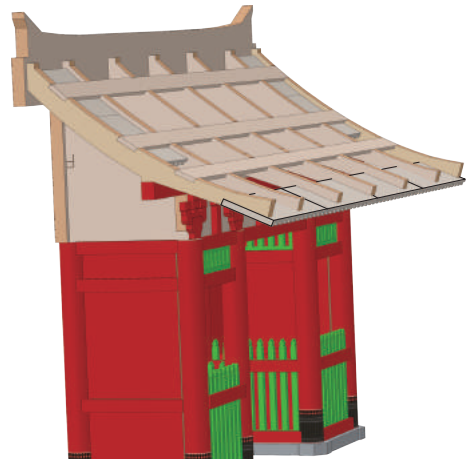
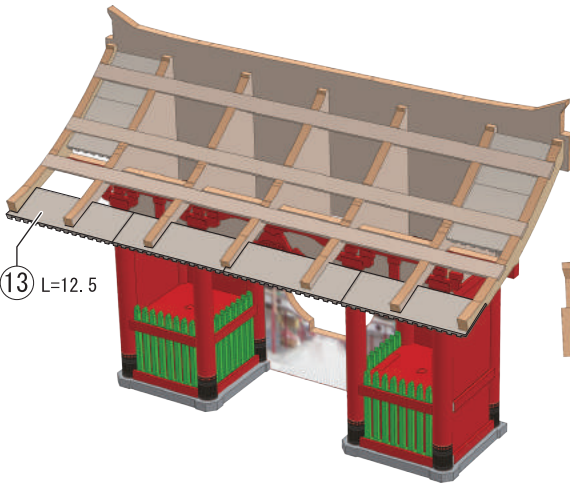

12 <Attach the second section of rafters>

- Attach the rafter (14) L=18
The rafter should overlap on the 1st layer

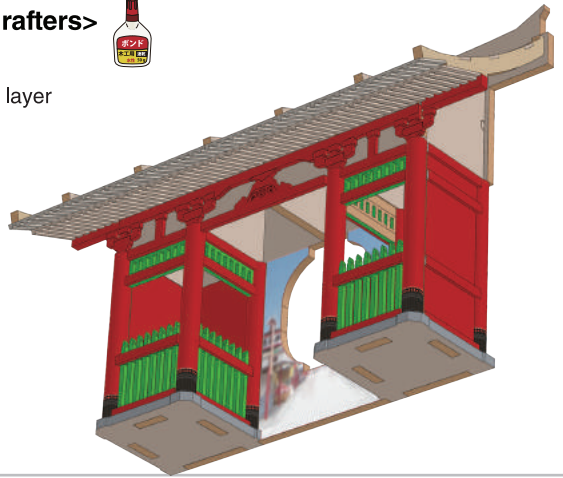
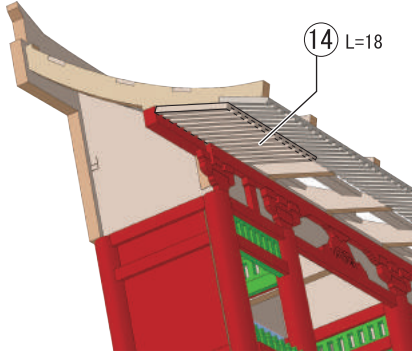

13 <Attach the girders: 1>

- (9) D ※ Same for (9) C

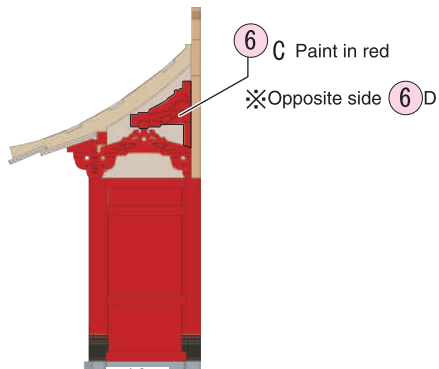
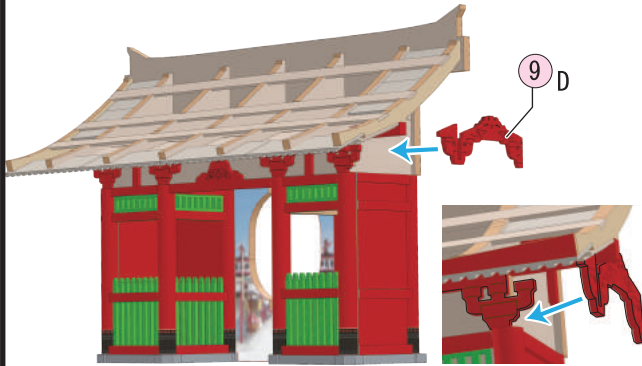
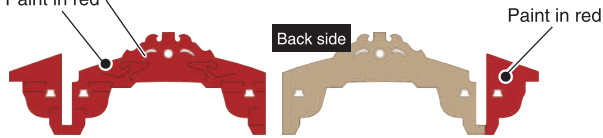

14 <Attach the girders: 2>

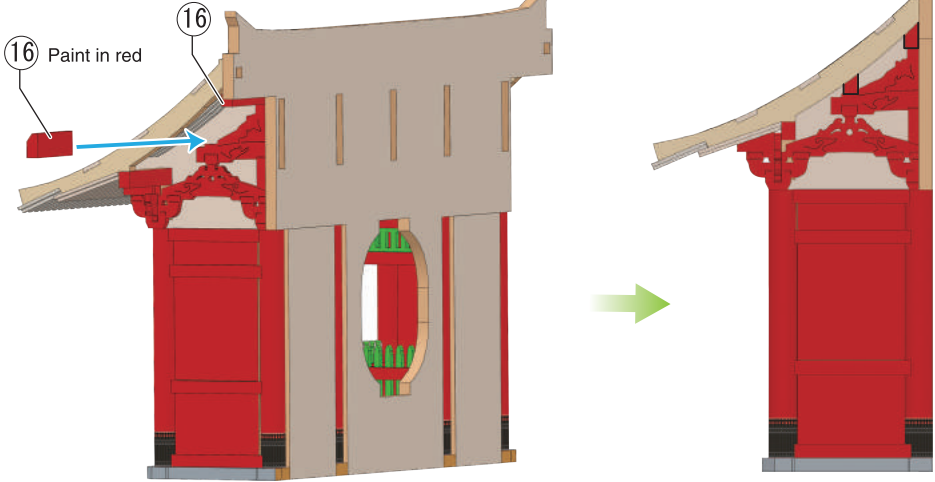

15 <Attach the eaves plate and gable boards>



- Paint (8) A in red and attach on the edge of the eaves and the rafters.
- Paint (7) A & C in red and attach the gold stickers (10) on the appropriate place as the image.

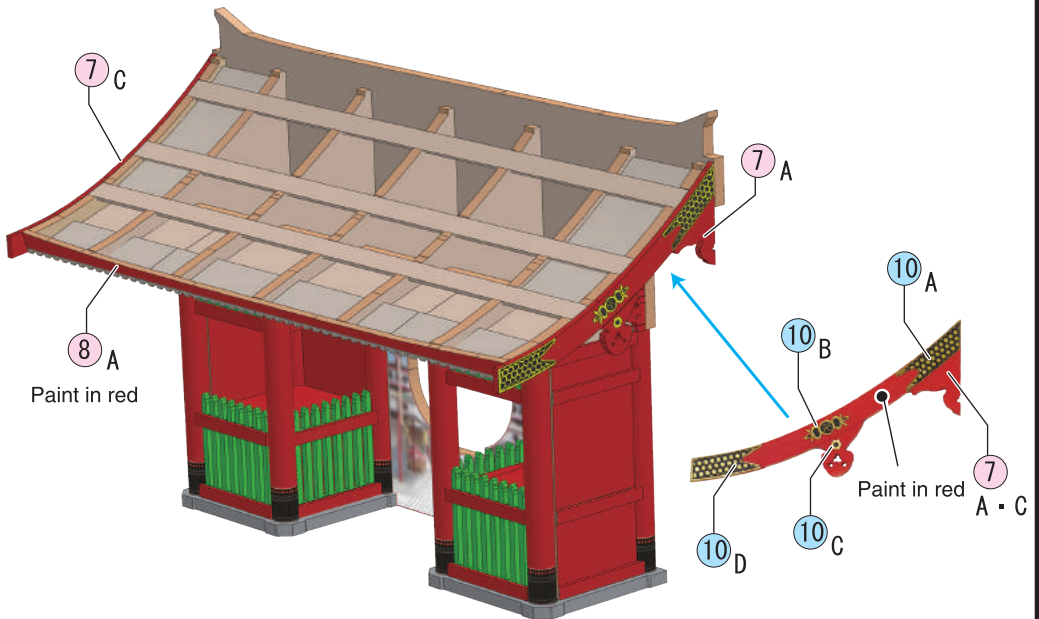

16 <Attach the roof tiles>



● Bend the roof tile sheet to fit the curve of the roof.

● Bend and reform the sheet little by little by pressing it onto a tool which have a cylindrical surface.

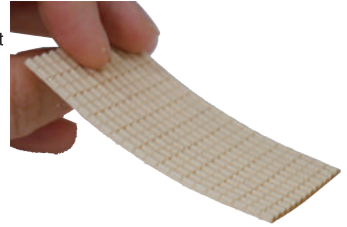
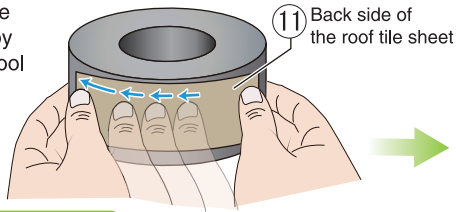

Attach the roof tile sheet by setting it to the upper corner of the roof materials.

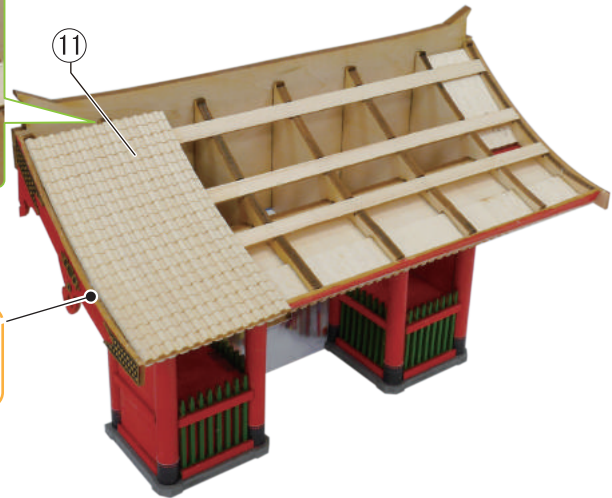

Do NOT attach it on the gable board

● Attach 4 roof tile sheets

※ It is recommended to use bulldog clips for glueing.

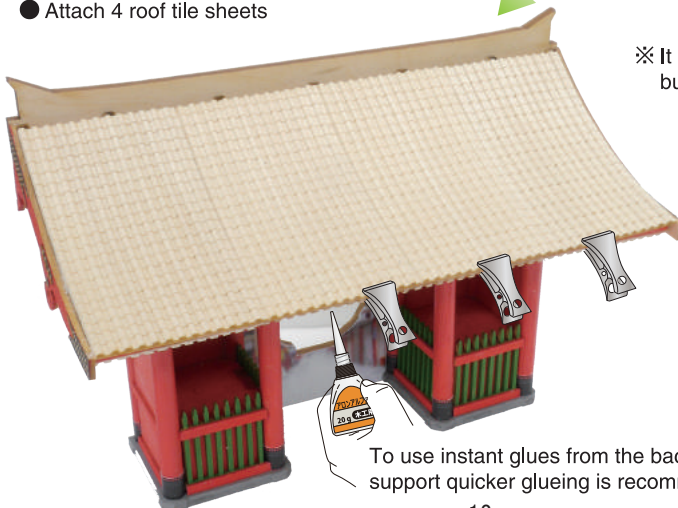

Bulldog clips



To use instant glues from the back side to support quicker glueing is recommended.

17 <Attach the ridge tiles>

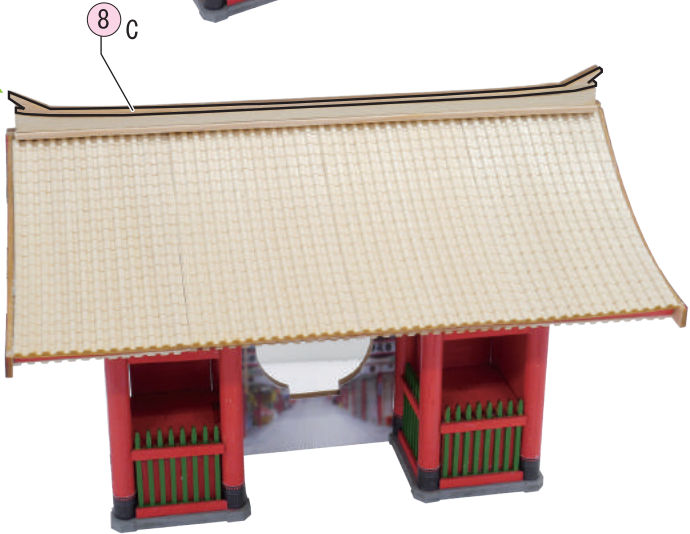
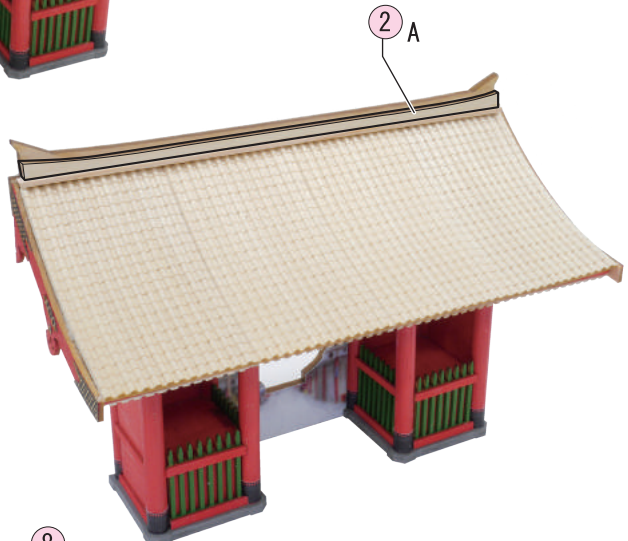

18 <Attach the corner ridges, the gargoyles and the eaves tiles>



- Attach ⑦ B on ① I. Make sure to align ⑦ B on the center of ① I. Make about 2mm spaces each side
- Attach the part on the roof tiles

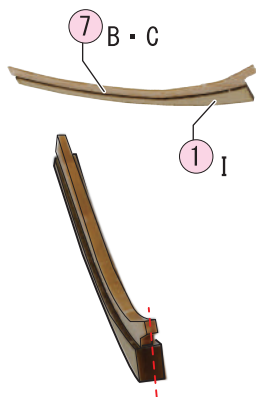

Align the centers

Make about 2mm spaces each side



※ Same for the opposite side

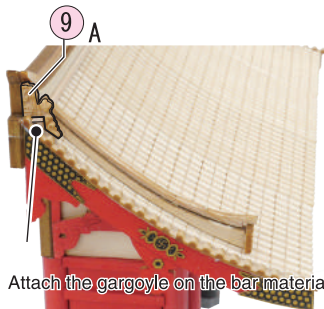

Attach the gargoyle on the bar material

- Glue the eaves tiles ⑫ on the side face of the gable board.

Eaves tiles ⑫

※ Same for the opposite sides



19 <Paint the roof tiles and attach the wedges and the architraves>



● Paint the entire roof in grey



Front view

Side view

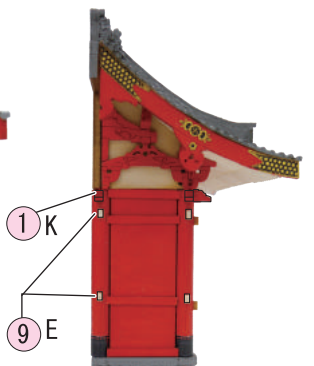
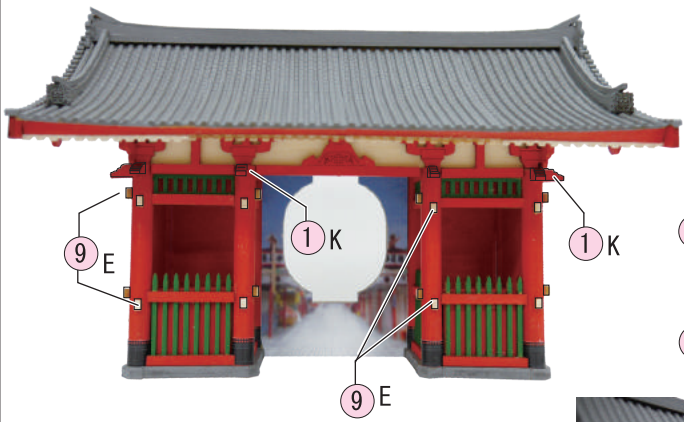
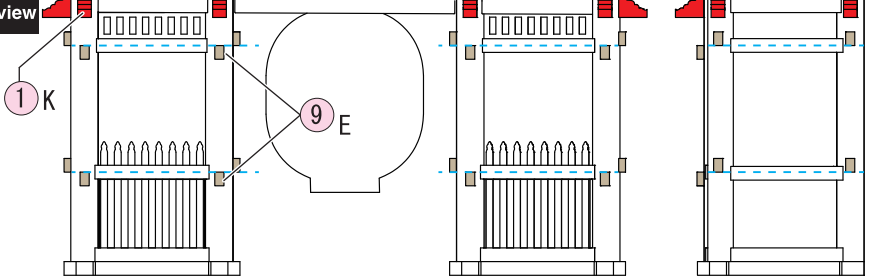

20 <Assemble the lantern: 1>



- Assemble the frames of the lantern.

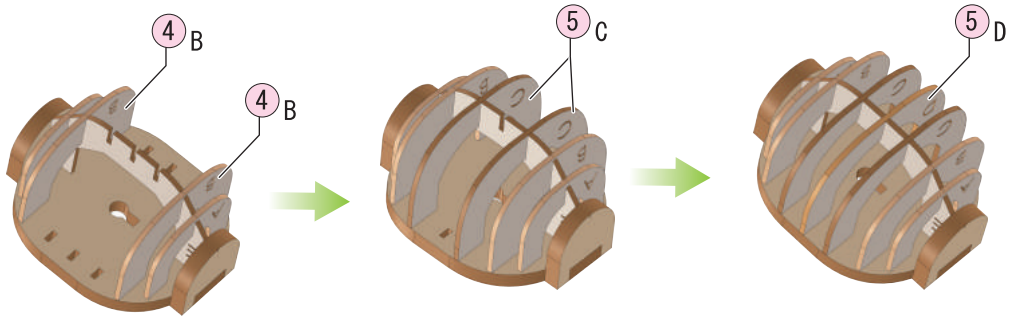
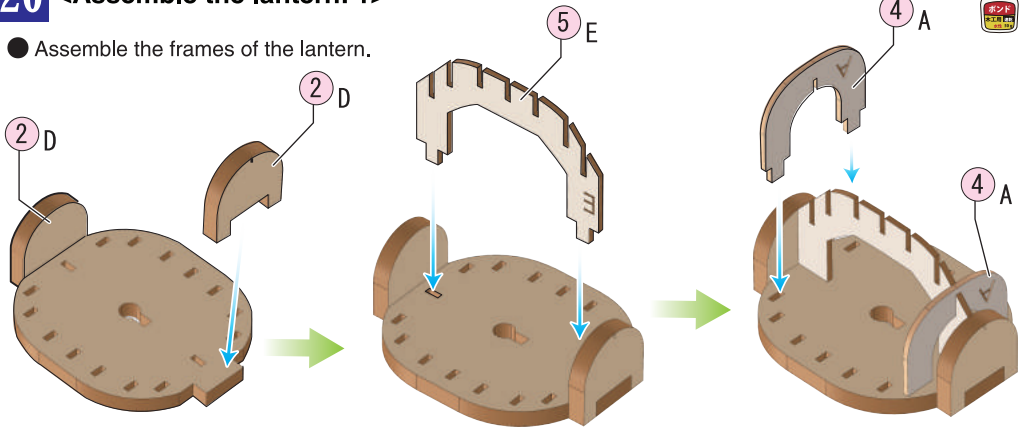

- Cut out the lantern sheet along the peripheral line and fold



- Apply the bond in thin on the back side of the sheet, and paste it on the lantern frame

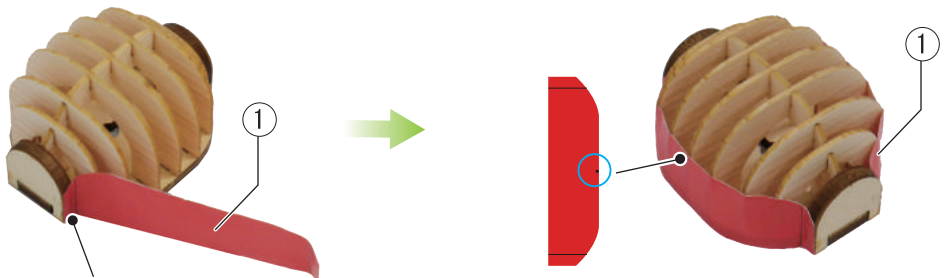

Paste the top part and fix it towards the bottom

Align it to the center of the frame

21 <Assemble the lantern: 2>



- Paste the lantern sheet ② by overlapping ①'s center line.

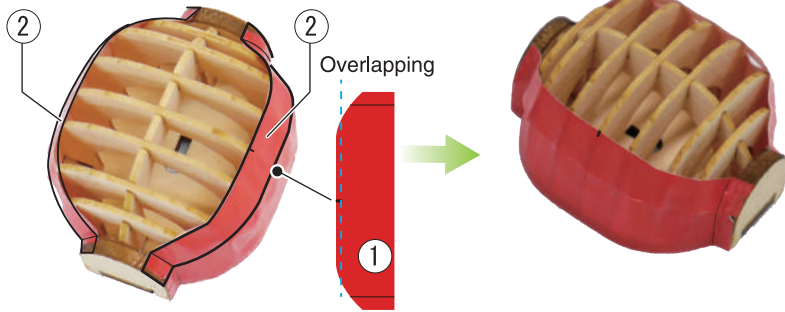

- Check the back side of lantern to confirm the top side and paste the "Kaminarimon" letter sheet.

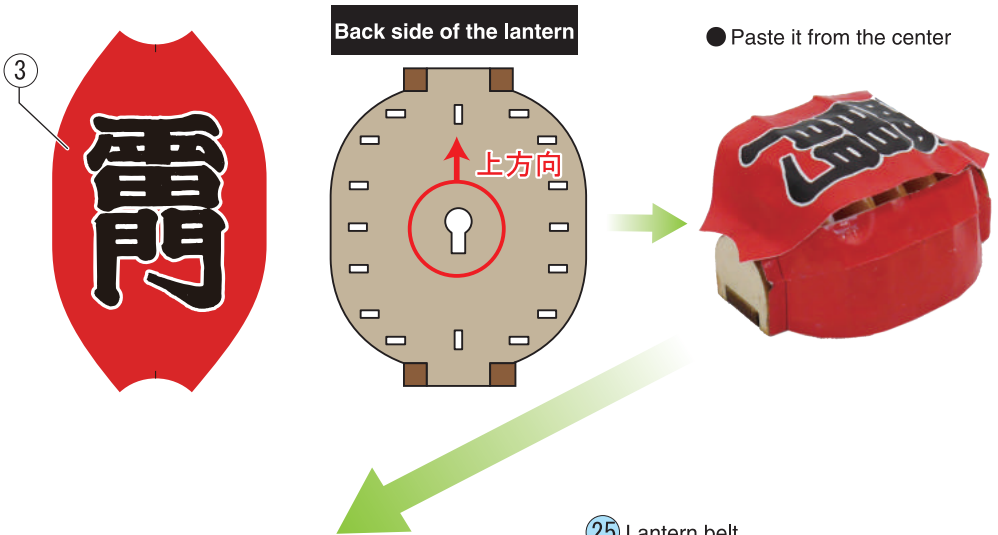



22 <Attach the lantern>

- Insert the lantern into the hole on the back wall plate and glue.



Back side

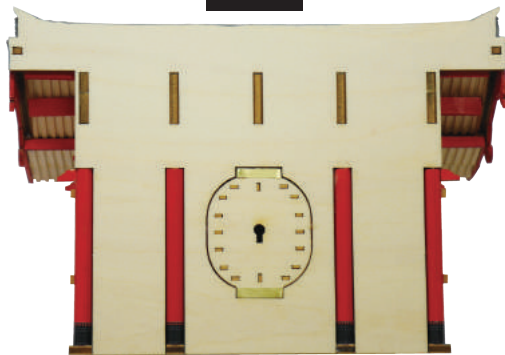

23 <Attach the Wind God & the Thunder God>

Thunder God (Raijin)



Paint in any color as you like.

Paint in any color as you like.

- Insert the circle of drums into the rest of two holes on ①L and glue.

Insert the projected part in the hole on ①L and glue.



Wind God (Fujin)

Insert the edge of the bags in the hole and glue.

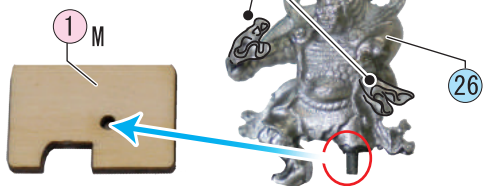

- Insert the projected part in the hole on ①M and glue.



- Place the Wind God and the Thunder God

Thunder God (Raijin)

Wind God (Fujin)



24 <Attach the stone floor>

- Paint the stone floor in grey.

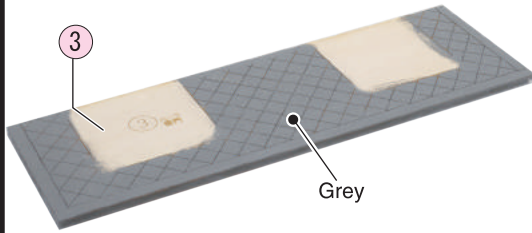

Attach the main body on the floor according to the recessed lines.

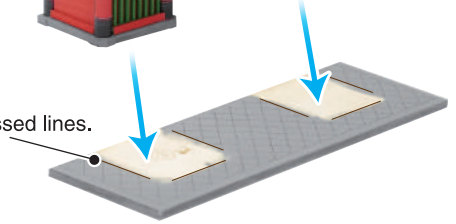

25 <Assemble and attach the decoration base>

- Glue (21) and (22) as the image

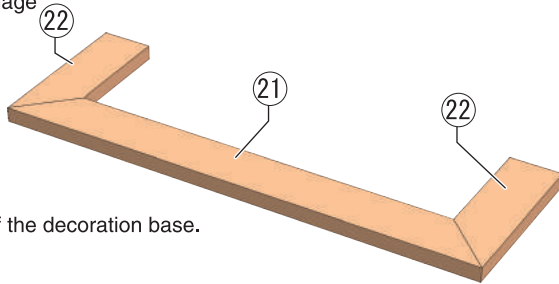

- Attach [24] on the center of the decoration base.



Back side

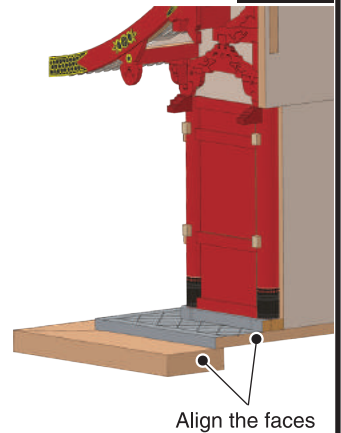

26 <Attach the light bulb>

Battery box

29

28 Light bulb

Back side

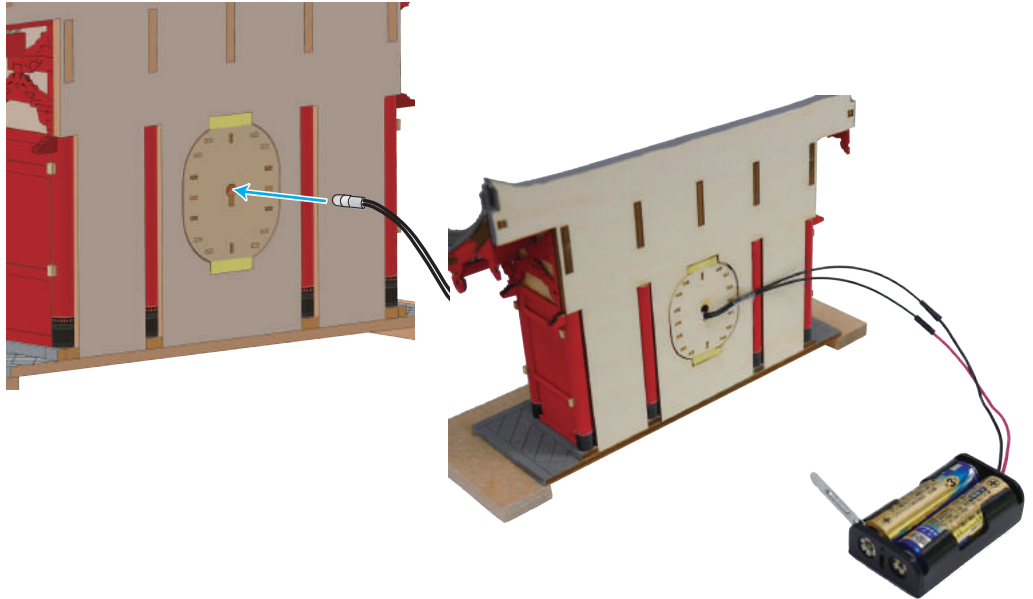

[Finish]

- Put 2 AA batteries and attach the assembled battery box cover.

23 Battery box cover

ON

